

INHEX screwdriver sockets 1/4", metric

44

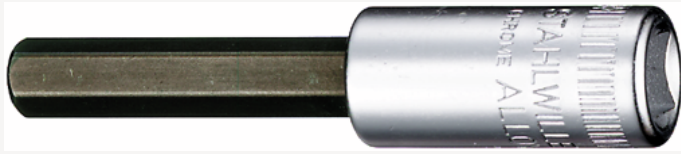

Product no. **01050004**
GTIN **4018754000487**
Model **44 4 INHEX**



Label. INHEX screwdriver socket 1/4 " 4mm L.55mm

- Properties.**
- for hex socket head screws
 - 1/4" internal square drive
 - Chrome Alloy Steel, chrome-plated
 - DIN 7422

Technical drawing.

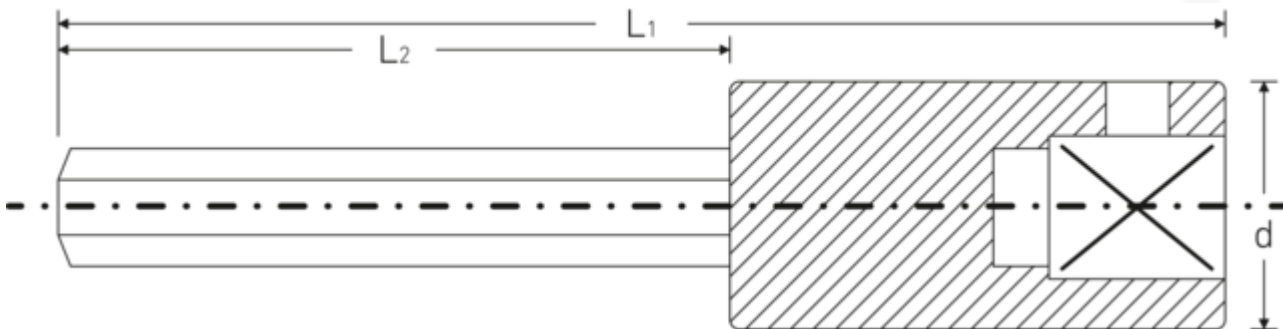

Technical attributes.

External output hex (mm)	4 mm
Square drive inner (inch)	1/4 "
L1	55 mm
L2	30 mm
Drive profile	Hex
d	10,7 mm

Logistics data.

Product no.	01050004
GTIN	4018754000487
Weight (g)	20 g
Volume (packaged, dm ³)	0.0432 dm ³
Packing standard	5
WEEE/ElektroG	nicht ear-pflichtig

DIN	DIN 7422	Customs tariff no.	82042000
Alloy	Chrome Alloy Steel, chrom plated	Country of origin AWR	GERMANY
		Region of origin	Nordrhein-Westfalen
		Depth mm (IFS)	55
		Width mm (IFS)	11
		Height mm (IFS)	11
		Weight (gross, kg)	0,075
		Weight PAP (kg)	0,000
		Weight PVC (kg)	0,002
		Length (packaged, mm)	80
		Width (packaged, mm)	45
		Height (packaging, mm)	12

GTIN.



STAHLWILLE Eduard Wille GmbH

Lindenallee 27 · 42349 Wuppertal · Germany · Phone: +49 202 4791-0

info@stahlwille.de · www.stahlwille.com

© STAHLWILLE Eduard Wille GmbH, Wuppertal