

POWER

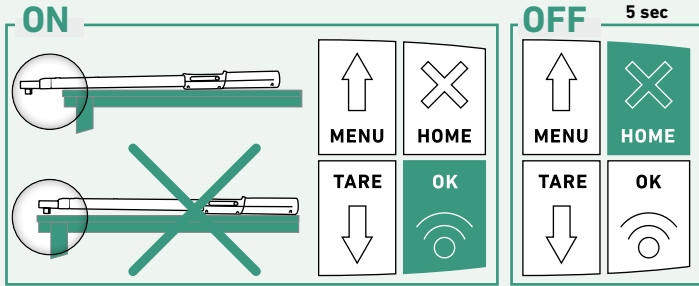

DISPLAY

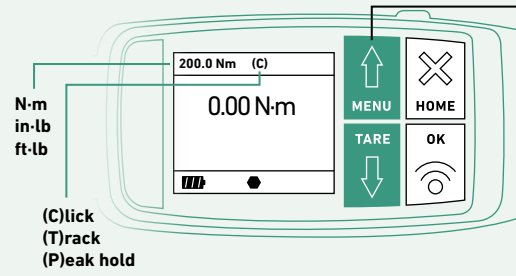

QUICK SETTING

- A 2 x Click**
- B** ↑ 110.0 N·m
↓ 100.0 N·m
↓ 90.0 N·m
- C Press OK**

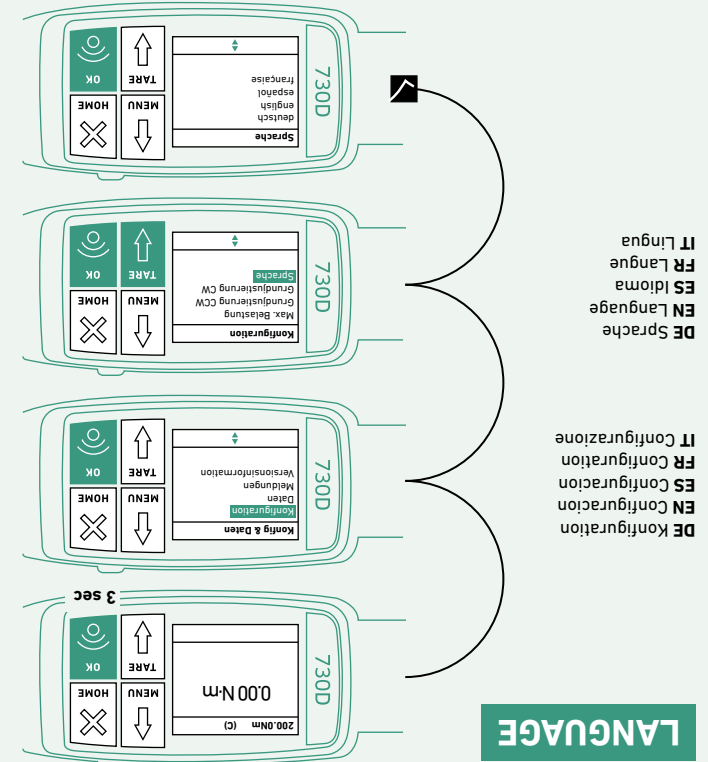

LANGUAGE

- DE Sprache
- EN Language
- ES Idioma
- FR Langue
- IT Lingua
- DE Konfiguration
- EN Configuration
- ES Configuración
- FR Configuration
- IT Configurazione

TOOLS THAT ... inspire

© STAHLWILLE Edward Wille GmbH // 1-11-25 MMB // V.2.0 // 91974045
 STAHLWILLE Edward Wille GmbH - Lindentallee 27 - 42349 Wuppertal - Germany
 Tel.: +49 202 4791-0 - info@stahlwille.de - www.stahlwille.com

MANOSKOP® 730D eClick
Short instructions



MADE IN CRONENBERG
MADE IN GERMANY

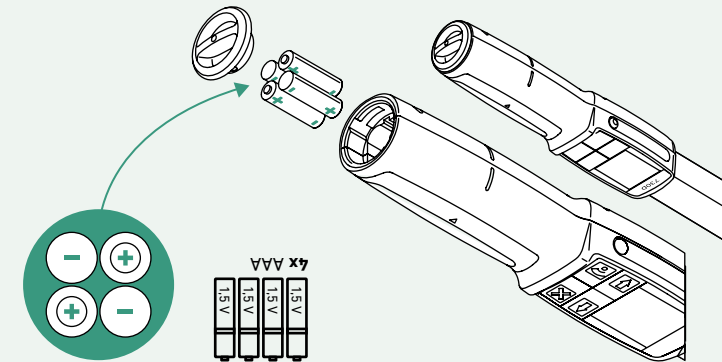
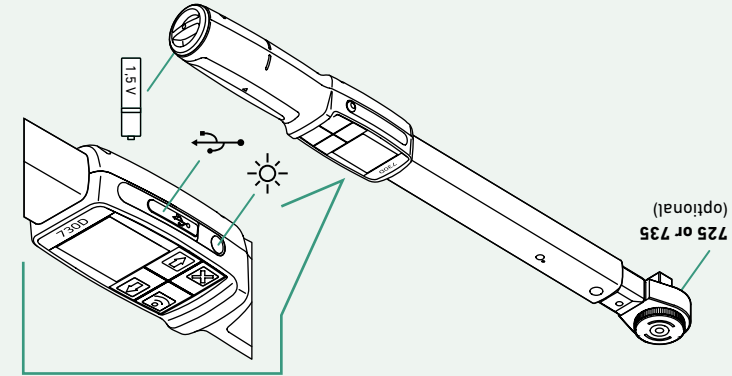

! DE Verpackungsinhalt
 EN Contents
 ES Contenido del embalaje
 FR Contenu du packaging
 IT Contenuto della confezione

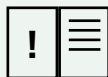

www.stahlwille.com/
 en_de/products/
 detail/851204

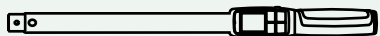

1x



1x



4x AAA

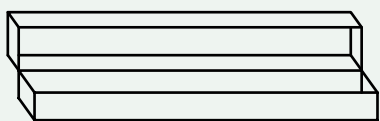

1x



2x

4 EN Setup Menu > Nm
 ES Entrada Directa > Nm
 FR Menu Direct > Nm
 IT Impostazione diretta > Nm

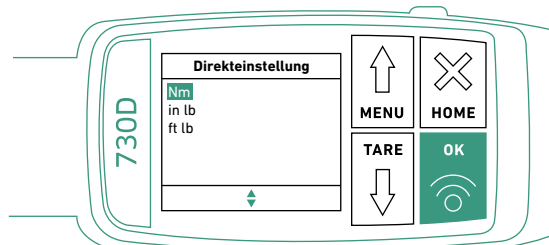

8 EN Setup Menu > Click
 ES Entrada Directa > Disparo
 FR Menu Direct > Déclenchement
 IT Impostazione diretta > Scatto

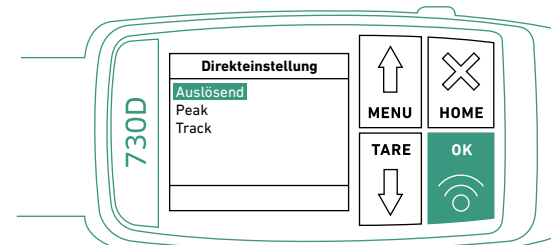

1 DE Praxisbeispiel
 EN Practical example
 ES Ejemplo práctico
 FR Exemple pratique
 IT Esempio pratico

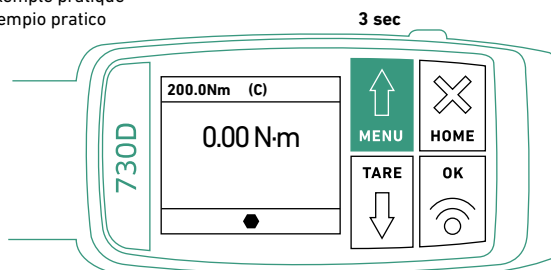

5 EN Setup Menu > Torque
 ES Entrada Directa > Par de apriete
 FR Menu Direct > Couple
 IT Impostazione diretta > Coppia

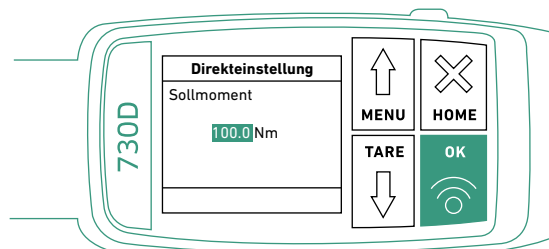

9 EN Setup Menu > Extension Length
 ES Entrada Directa > Cota del util
 FR Menu Direct > Longueur embout
 IT Impostazione diretta > Misura di estensione

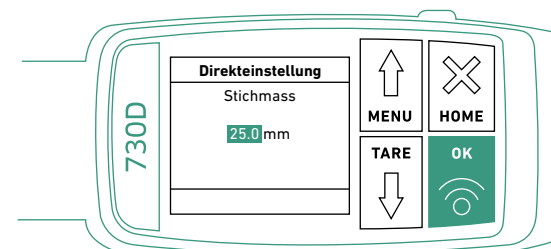

2 EN Main Menu > Direct Input
 ES Menu Principal > Entrada directa
 FR Menu Principal > Mode direct
 IT Menu principale > Metodo diretto

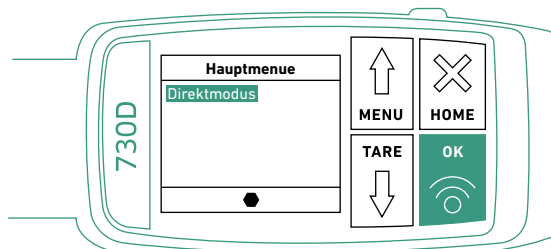

6 EN Setup Menu > Rel. Tolerance
 ES Entrada Directa > Tolerancia relativa
 FR Menu Direct > Tolérances rel.
 IT Impostazione diretta > Tolleranza rel.

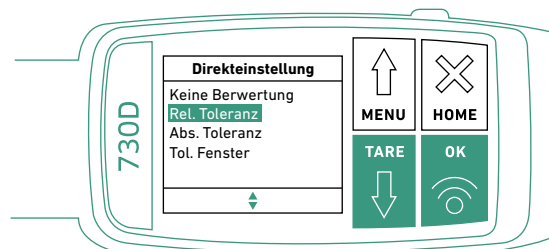

10 EN Setup Menu > Joint-ID
 ES Entrada Directa > Joint-ID
 FR Menu Direct > Joint-ID
 IT Impostazione diretta > Joint-ID

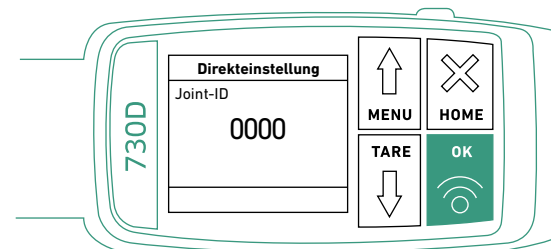

3 EN Setup Menu > Torque
 ES Entrada Directa > Par de apriete
 FR Menu Direct > Couple
 IT Impostazione diretta > Coppia

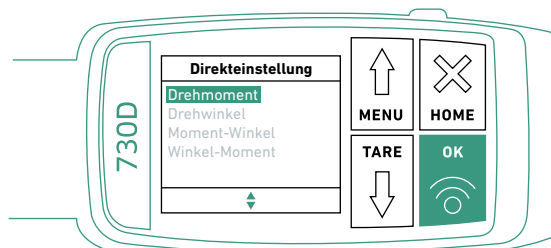

7 EN Setup Menu > Torque +Tol 10 % | Torque -Tol 0 %
 ES Entrada Directa > Apriete +Tol 10 % | Apriete -Tol 0 %
 FR Menu Direct > Couple +Tol 10 % | Couple -Tol 0 %
 IT Impostazione diretta > Coppia +Toll... | Coppia -Toll...

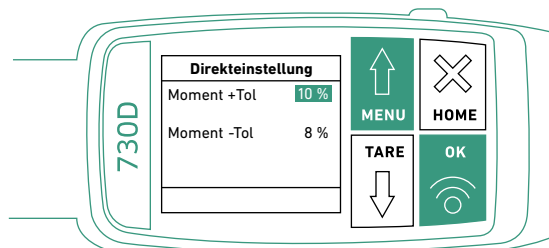

11 EN Parameter
 ES Parametro
 FR Paramètres
 IT Parametri

READY

