



IMPACT sockets 1/2"

50IMP

Product no. **23010024**
GTIN **4018754015092**
Model **50 IMP 24**



Label. IMPACT socket 1/2 " 24mm L.44mm

- Properties.**
- with hex
 - 1/2" internal square drive
 - DIN 3129 / ISO 1711-2
 - Chrome Alloy Steel, gunmetal finish

Product highlights.



Optimised functionality.

All IMPACT sockets have a through cross hole for the connecting pin and a deep groove for the rubber locking ring. The locking pin is not stressed during use.

High fitting accuracy.

The high fitting accuracy due to tight tolerances guarantees optimum, backlash-free transmission of forces to the socket.



**PRODUCT IMAGE
IN PROGRESS**

Technical drawing.

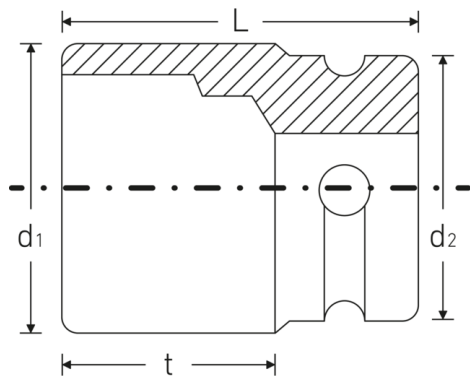

Technical attributes.

Size [mm]	24 mm
Square drive inner (inch)	1/2 "
Length mm (L)	44 mm
Drive profile	hex
d1	35 mm
d2	30 mm
DIN	DIN 3129 / ISO 1711-2
t	28 mm

Logistics data.

Product no.	23010024
GTIN	4018754015092
Weight (g)	164 g
Volume (packaged, dm3)	0.2898 dm3
Packing standard	5
WEEE/ElektroG	nicht ear-pflichtig
Customs tariff no.	82042000
Country of origin AWR	GERMANY
Region of origin	Nordrhein-Westfalen
Depth mm (IFS)	44
Width mm (IFS)	35
Height mm (IFS)	35
Weight (gross, kg)	0,820
Weight PAP (kg)	0,000
Weight PVC (kg)	0,006
Length (packaged, mm)	175
Width (packaged, mm)	36
Height (packaging, mm)	46

GTIN.



Accessories (for).



39012440
IMPACT rubber ring