

## IMPACT sockets 1/2"

### 51IMP



Product no. 23020019  
GTIN 4018754015177  
Model 51 IMP 19



**Label.** IMPACT socket 1/2 " 19mm L.85mm

- Properties.**
- deep version
  - with hex
  - 1/2" internal square drive
  - Chrome Alloy Steel, gunmetal finish
  - DIN 3129 / ISO 1711-2



## Product highlights.



### Optimised functionality.

All IMPACT sockets have a through cross hole for the connecting pin and a deep groove for the rubber locking ring. The locking pin is not stressed during use.



PRODUCT IMAGE  
IN PROGRESS

### High fitting accuracy.

The high fitting accuracy due to tight tolerances guarantees optimum, backlash-free transmission of forces to the socket.

## Technical drawing.

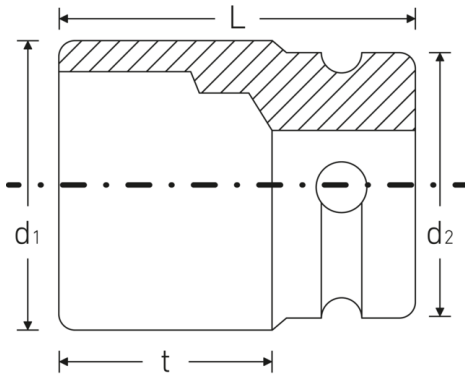

## Technical attributes.

Size [mm]	19 mm
Square drive inner (inch)	1/2 "
Length mm (L)	85 mm
Drive profile	hex
d1	28,8 mm
d2	30 mm
t	67,5 mm

## Logistics data.

Product no.	23020019
GTIN	4018754015177
Weight (g)	292 g
Volume (packaged, dm <sup>3</sup> )	0.402566 dm <sup>3</sup>
Packing standard	5
WEEE/ElektroG	nicht ear-pflichtig
Customs tariff no.	82042000
Country of origin AWR	GERMANY
Region of origin	Nordrhein-Westfalen
Depth mm (IFS)	85
Width mm (IFS)	30
Height mm (IFS)	30
Weight (gross, kg)	1,468
Weight PAP (kg)	0,000
Weight PVC (kg)	0,007
Length (packaged, mm)	151
Width (packaged, mm)	31
Height (packaging, mm)	86

**GTIN.**



**STAHLWILLE Eduard Wille GmbH**

Lindenallee 27 · 42349 Wuppertal · Germany · Phone: +49 202 4791-0

[info@stahlwille.de](mailto:info@stahlwille.de) · [www.stahlwille.com](http://www.stahlwille.com)

© STAHLWILLE Eduard Wille GmbH, Wuppertal