



Uniflex sockets 1/2", metric

53

Product no. 03040016
GTIN 4018754006199
Model 53 16



Label. 1/2 " Uniflex sockets Size 16mm L.69mm

- Properties.**
- hex with AS-Drive profile
 - 1/2" internal square drive
 - Chrome Alloy Steel, chrome-plated

Technologies and features.



High Performance Quality (HPQ®)

Our HPQ® tool is made of wear-resistant high-performance steel, yet is thin-walled and lightweight. It withstands high torques and is ideal for work in confined spaces such as turbines.

Technical drawing.

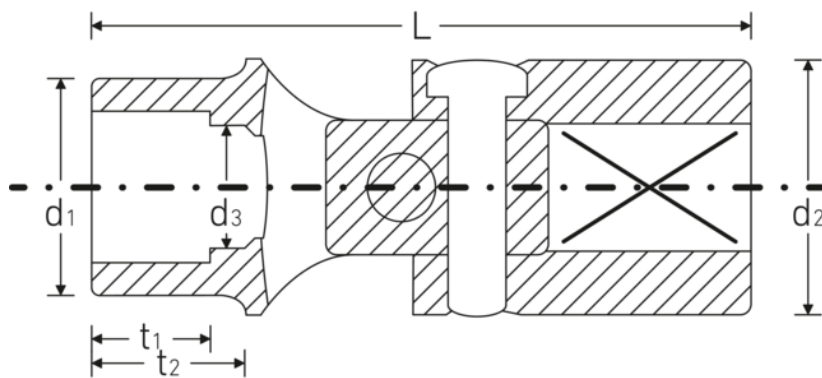

Technical attributes.

Size [mm]	16 mm
Square drive inner (inch)	1/2 "
Length mm (L)	69 mm
Drive profile	hex AS-Drive
d1	22,4 mm
d2	25 mm
d3	15 mm
Alloy	Chrome Alloy Steel, chrom plated
t2	17 mm

Logistics data.

Product no.	03040016
GTIN	4018754006199
Weight (g)	141 g
Volume (packaged, dm3)	0.0507 dm3
Packing standard	1
WEEE/ElektroG	nicht ear-pflichtig
Customs tariff no.	82042000
Country of origin AWR	GERMANY
Region of origin	Nordrhein-Westfalen
Depth mm (IFS)	71
Width mm (IFS)	25
Height mm (IFS)	25
Weight (gross, kg)	0,144
Weight PAP (kg)	0,000
Weight PVC (kg)	0,002
Length (packaged, mm)	75
Width (packaged, mm)	26
Height (packaging, mm)	26

GTIN.





STAHLWILLE Eduard Wille GmbH

Lindenallee 27 · 42349 Wuppertal · Germany · Phone: +49 202 4791-0

info@stahlwille.de · www.stahlwille.com

© STAHLWILLE Eduard Wille GmbH, Wuppertal