



## IMPACT sockets TORX® 1/2"

### 2308TX IMP

Product no. **23080024**  
GTIN **4018754015337**  
Model **2308TX IMP E24 TORX®**



**Label.** IMPACT socket 1/2 " E24 L.41.2mm

- Properties.**
- for external TORX® screws
  - 1/2" internal square drive
  - Chrome Alloy Steel, gunmetal finish

## Product highlights.



### Optimised functionality.

All IMPACT sockets have a through cross hole for the connecting pin and a deep groove for the rubber locking ring. The locking pin is not stressed during use.

### High fitting accuracy.

The high fitting accuracy due to tight tolerances guarantees optimum, backlash-free transmission of forces to the socket.



**PRODUCT IMAGE  
IN PROGRESS**

## Technical drawing.

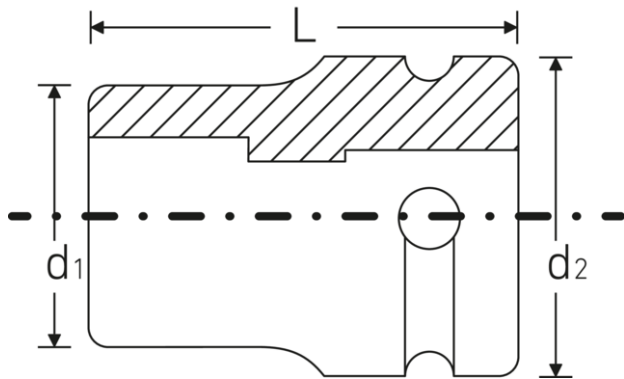

## Technical attributes.

Size drive profile	E24
TORX® drive profile (mm)	22,1 mm
Square drive inner (inch)	1/2 "
Length mm (L)	41,2 mm
Drive profile	TORX®
d1	30 mm
d2	30 mm

## Logistics data.

Product no.	23080024
GTIN	4018754015337
Weight (g)	149 g
Volume (packaged, dm3)	0.5355 dm3
Packing standard	10
WEEE/ElektroG	nicht ear-pflichtig
Customs tariff no.	82042000
Country of origin AWR	GERMANY
Region of origin	Nordrhein-Westfalen
Depth mm (IFS)	42
Width mm (IFS)	30
Height mm (IFS)	30
Weight (gross, kg)	1,490
Weight PAP (kg)	0,000
Weight PVC (kg)	0,008
Length (packaged, mm)	170
Width (packaged, mm)	70
Height (packaging, mm)	45

## GTIN.



## Accessories (for).



39012440  
IMPACT rubber ring