



IMPACT sockets TORX® 1/2"

2308TX IMP

Product no. **23080014**
GTIN **4018754015290**
Model **2308TX IMP E14 TORX®**



Label. IMPACT socket 1/2 " E14 L.38mm

- Properties.**
- for external TORX® screws
 - 1/2" internal square drive
 - Chrome Alloy Steel, gunmetal finish

Product highlights.



Optimised functionality.

All IMPACT sockets have a through cross hole for the connecting pin and a deep groove for the rubber locking ring. The locking pin is not stressed during use.

High fitting accuracy.

The high fitting accuracy due to tight tolerances guarantees optimum, backlash-free transmission of forces to the socket.



**PRODUCT IMAGE
IN PROGRESS**

Technical drawing.

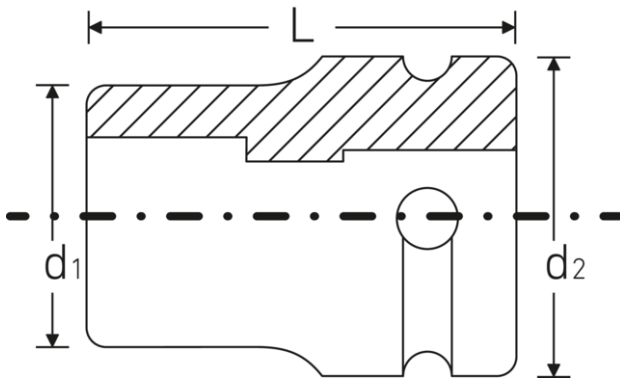

Technical attributes.

Size drive profile	E14
TORX® drive profile (mm)	12,9 mm
Square drive inner (inch)	1/2 "
Length mm (L)	38 mm
Drive profile	TORX®
d1	17,7 mm
d2	25 mm

Logistics data.

Product no.	23080014
GTIN	4018754015290
Weight (g)	73 g
Volume (packaged, dm3)	0.4725 dm3
Packing standard	10
WEEE/ElektroG	nicht ear-pflichtig
Customs tariff no.	82042000
Country of origin AWR	GERMANY
Region of origin	Nordrhein-Westfalen
Depth mm (IFS)	38
Width mm (IFS)	25
Height mm (IFS)	25
Weight (gross, kg)	0,730
Weight PAP (kg)	0,000
Weight PVC (kg)	0,006
Length (packaged, mm)	150
Width (packaged, mm)	70
Height (packaging, mm)	45

GTIN.



Accessories (for).



39011940
IMPACT rubber ring