

IMPACT sockets 1/2"

50IMP

Product no. **23010013**
GTIN **4018754014989**
Model **50 IMP 13**



Label. IMPACT socket 1/2 " 13mm L.38mm

- Properties.**
- with hex
 - 1/2" internal square drive
 - DIN 3129 / ISO 1711-2
 - Chrome Alloy Steel, gunmetal finish

Product highlights.



Optimised functionality.

All IMPACT sockets have a through cross hole for the connecting pin and a deep groove for the rubber locking ring. The locking pin is not stressed during use.

High fitting accuracy.

The high fitting accuracy due to tight tolerances guarantees optimum, backlash-free transmission of forces to the socket.



**PRODUCT IMAGE
IN PROGRESS**

Technical drawing.

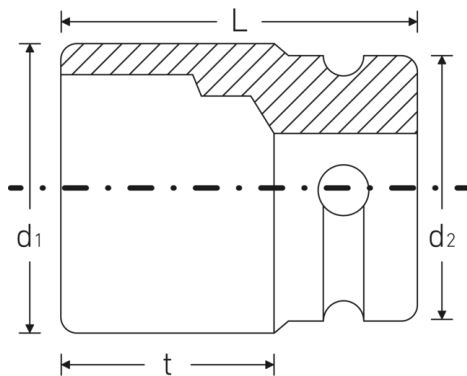

Technical attributes.

Size [mm]	13 mm
Square drive inner (inch)	1/2 "
Length mm (L)	38 mm
Drive profile	hex
d1	20,8 mm
d2	25 mm
DIN	DIN 3129 / ISO 1711-2
t	21,5 mm

Logistics data.

Product no.	23010013
GTIN	4018754014989
Weight (g)	85 g
Volume (packaged, dm3)	0.336 dm3
Packing standard	10
WEEE/ElektroG	nicht ear-pflichtig
Customs tariff no.	82042000
Country of origin AWR	GERMANY
Region of origin	Nordrhein-Westfalen
Depth mm (IFS)	38
Width mm (IFS)	25
Height mm (IFS)	25
Weight (gross, kg)	0,865
Weight PAP (kg)	0,000
Weight PVC (kg)	0,006
Length (packaged, mm)	140
Width (packaged, mm)	60
Height (packaging, mm)	40

GTIN.



Accessories (for).



39011940
IMPACT rubber ring