

## INHEX screwdriver sockets 1/4", metric

44

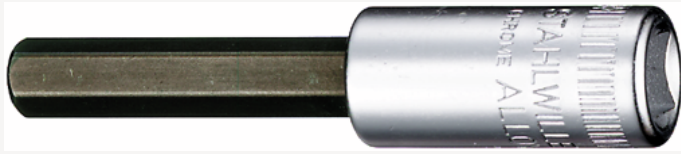

Product no. **01050025**  
GTIN **4018754344000**  
Model **44 2,5 INHEX**



**Label.** INHEX screwdriver socket 1/4 " 2,5mm L.55mm

**Properties.**

- for hex socket head screws
- 1/4" internal square drive
- Chrome Alloy Steel, chrome-plated
- DIN 7422

### Technical drawing.

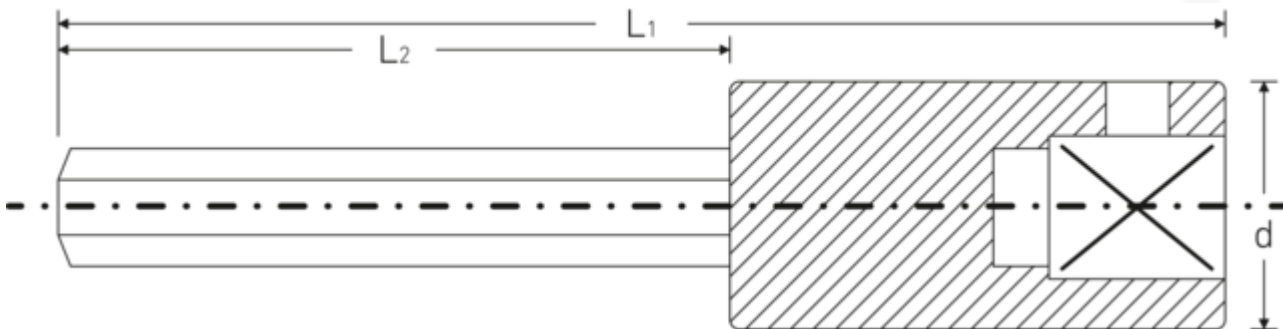

### Technical attributes.

External output hex (mm)	2,5 mm
Square drive inner (inch)	1/4 "
L1	55 mm
L2	30 mm
Drive profile	hex
d	10,7 mm

### Logistics data.

Product no.	01050025
GTIN	4018754344000
Weight (g)	18 g
Volume (packaged, dm <sup>3</sup> )	0.0363 dm <sup>3</sup>
Packing standard	5
WEEE/ElektroG	nicht ear-pflichtig

<b>DIN</b>	DIN 7422	<b>Customs tariff no.</b>	82079030
<b>Alloy</b>	Chrome Alloy Steel, chrom plated	<b>Country of origin AWR</b>	GERMANY
		<b>Region of origin</b>	Nordrhein-Westfalen
		<b>Depth mm (IFS)</b>	55
		<b>Width mm (IFS)</b>	20
		<b>Height mm (IFS)</b>	20
		<b>Weight (gross, kg)</b>	0,055
		<b>Weight PAP (kg)</b>	0,000
		<b>Weight PVC (kg)</b>	0,000
		<b>Length (packaged, mm)</b>	75
		<b>Width (packaged, mm)</b>	22
		<b>Height (packaging, mm)</b>	22

## GTIN.



**STAHLWILLE Eduard Wille GmbH**

Lindenallee 27 · 42349 Wuppertal · Germany · Phone: +49 202 4791-0

info@stahlwille.de · www.stahlwille.com

© STAHLWILLE Eduard Wille GmbH, Wuppertal