



IMPACT sockets 1/2"

50IMP

Product no. **23010017**
GTIN **4018754015023**
Model **50 IMP 17**



Label. IMPACT socket 1/2 " 17mm L.38mm

- Properties.**
- with hex
 - 1/2" internal square drive
 - DIN 3129 / ISO 1711-2
 - Chrome Alloy Steel, gunmetal finish

Product highlights.



Optimised functionality.

All IMPACT sockets have a through cross hole for the connecting pin and a deep groove for the rubber locking ring. The locking pin is not stressed during use.

High fitting accuracy.

The high fitting accuracy due to tight tolerances guarantees optimum, backlash-free transmission of forces to the socket.



**PRODUCT IMAGE
IN PROGRESS**

Technical drawing.

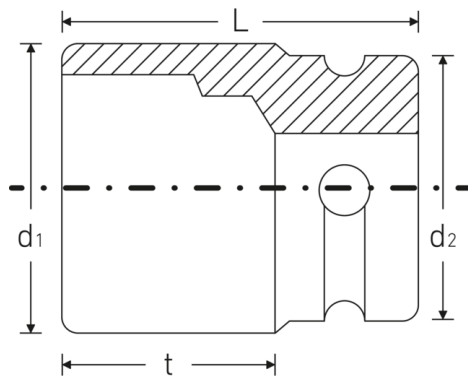

Technical attributes.

Size [mm]	17 mm
Square drive inner (inch)	1/2 "
Length mm (L)	38 mm
Drive profile	hex
d1	26,2 mm
d2	30 mm
DIN	DIN 3129 / ISO 1711-2
t	22,9 mm

Logistics data.

Product no.	23010017
GTIN	4018754015023
Weight (g)	132 g
Volume (packaged, dm3)	0.504 dm3
Packing standard	10
WEEE/ElektroG	nicht ear-pflichtig
Customs tariff no.	82042000
Country of origin AWR	GERMANY
Region of origin	Nordrhein-Westfalen
Depth mm (IFS)	38
Width mm (IFS)	30
Height mm (IFS)	30
Weight (gross, kg)	1,310
Weight PAP (kg)	0,000
Weight PVC (kg)	0,008
Length (packaged, mm)	160
Width (packaged, mm)	70
Height (packaging, mm)	45

GTIN.



Accessories (for).



39012440
IMPACT rubber ring