

IMPACT sockets 1/2"

51IMP



Product no. 23020013
GTIN 4018754015139
Model 51 IMP 13



Label. IMPACT socket 1/2 " 13mm L.85mm

Properties.

- deep version
- with hex
- 1/2" internal square drive
- Chrome Alloy Steel, gunmetal finish
- DIN 3129 / ISO 1711-2



Product highlights.



Optimised functionality.

All IMPACT sockets have a through cross hole for the connecting pin and a deep groove for the rubber locking ring. The locking pin is not stressed during use.



PRODUCT IMAGE
IN PROGRESS

High fitting accuracy.

The high fitting accuracy due to tight tolerances guarantees optimum, backlash-free transmission of forces to the socket.

Technical drawing.

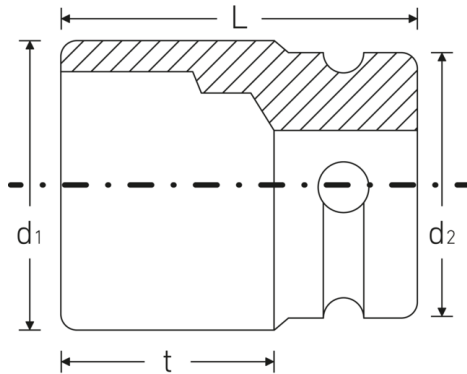

Technical attributes.

Size [mm]	13 mm
Square drive inner (inch)	1/2 "
Length mm (L)	85 mm
Drive profile	hex
d1	20,8 mm
d2	25 mm
t	68,5 mm

Logistics data.

Product no.	23020013
GTIN	4018754015139
Weight (g)	222 g
Volume (packaged, dm ³)	0.281736 dm ³
Packing standard	5
WEEE/ElektroG	nicht ear-pflichtig
Customs tariff no.	82042000
Country of origin AWR	GERMANY
Region of origin	Nordrhein-Westfalen
Depth mm (IFS)	85
Width mm (IFS)	25
Height mm (IFS)	25
Weight (gross, kg)	1,110
Weight PAP (kg)	0,000
Weight PVC (kg)	0,007
Length (packaged, mm)	126
Width (packaged, mm)	26
Height (packaging, mm)	86

GTIN.



STAHLWILLE Eduard Wille GmbH

Lindenallee 27 · 42349 Wuppertal · Germany · Phone: +49 202 4791-0

info@stahlwille.de · www.stahlwille.com

© STAHLWILLE Eduard Wille GmbH, Wuppertal