



QuickRelease fine-tooth flexible-joint ratchet

416QR



Product no. **11261010**
GTIN **4018754286362**
Model **416QR**



Label.

QR fine-tooth flexible ratchet 1/4 RSW.4.5° L.170mm

Properties.

- switchable
- 80 teeth
- with QuickRelease safety lock
- with 2-component handle
- handle lever up and down approx. 90° swivelling, engaging and locking in the following positions:
 - straight
 - 30° upwards
 - 60° upwards
 - 30° downwards
- releasing the lock by push button in the handle area
- for working in confined spaces, with working angle of only 4, 5°
- FOD-preventive due to screwless design
- simple release of the lock by push button in the handle area
- made of high-quality Chrome-Alloy-Steel
- DIN 3122/ISO 3315 - DBGM (German Federal Utility Model)

Benefits.

Reversible STAHLWILLE 1/4" fine-tooth ratchet with QR push button release.

Patented QuickRelease locking system secures every component from ratchet and the joint to the socket without loss of space.

The high-quality Chrome Alloy Steel construction promises a long service life.

80 teeth allow a practical working angle of just 4.5° - for even power transmission and precise use in the tightest spaces.

Ratchet head swivels 90°, lockable in 4 positions (0°; 30°/60° up; 30° down) - for hard-to-reach places.

Product highlights.



Ideal for continuous use.

The ratchet is made from high-quality forged chrome alloy steel and is also chrome-plated, giving it excellent robustness and durability, even in continuous use. It is designed for precise and reliable continuous use in passenger or commercial vehicle workshops, assembly and industry.

Technologies and features.



QuickRelease

The QuickRelease safety lock prevents unintentional loss of insert tools. These click securely into place, and are only released again at the push of a button for a quick tool change.



Foreign Object Damage

STAHLWILLE protects against FOD (Foreign Object Damage). Our tool is ideal for safety-relevant sectors such as aviation, thanks to the screwless design.



Fine-tooth ratchet mechanism

Our fine-tooth ratchets with 80 teeth re-engage after just 4.5° for maximum precision in confined spaces. 8 pairs of parallel teeth simultaneously ensure maximum load-bearing capacity and particularly smooth running, even at high torques.



2-component handle

Our 2-component handle is non-slip and ergonomically designed. It is resistant to the most common oils, greases, fuels, brake fluids, and Skydrol.

Technical attributes.

a	12 mm
External square drive (inch)	1/4
Number of teeth	80
Working angle	4.5 °
Width mm (b)	22,5 mm
DIN	DIN 3122 / ISO 3315

Logistics data.

Depth mm (IFS)	170
Width mm (IFS)	20
Height mm (IFS)	20
WEEE/ElektroG	nicht ear-pflichtig
Length (packed, mm)	220
Width (packed, mm)	30

Length mm (L)	170 mm	Height (packed, mm)	25
Alloy	Chrome Alloy Steel	Volume (packed, dm3)	0.165 dm3
Model no.	416QR	Art. no.	11261010
		Weight (gross, kg)	0,130
		Weight PAP (kg)	0,000
		Weight PVC (kg)	0,004
		GTIN	4018754286362
		Country of origin AWR	GERMANY
		Region of origin	Nordrhein-Westfalen
		Customs tariff no.	82042000
		Packing standard	1
		Weight	170 g

Variants.

Art. no.	Model no. (ERP)	Description	GTIN
11261010	416QR	QR fine-tooth flexible ratchet 1/4 RSW.4.5° L.170mm	4018754286362

GTIN.



Accessories (for).



11180010
Bit holder



11030003
Adapter

Images.

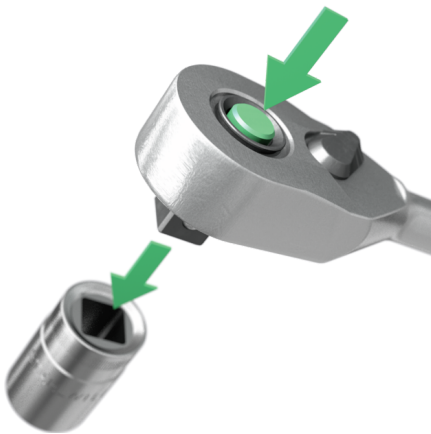

STAHLWILLE Eduard Wille GmbH & Co. KG

Lindenallee 27 · 42349 Wuppertal · Germany · Phone: +49 202 4791-0 · Fax: +49 202 4791-200
info@stahlwille.de · www.stahlwille.com · Copyright by STAHLWILLE Eduard Wille GmbH & Co. KG, Wuppertal
Copyright by STAHLWILLE Eduard Wille GmbH & Co. KG, Wuppertal