



## QR fine-tooth ratchet set, 1/4"+1/2"

415QR/512QR



Product no. 91336421  
GTIN 4018754342914  
Model 415QR/512QR Knarrensatz



Label.

QR fine tooth ratchet set 2



## Product highlights.



PRODUCT IMAGE  
IN PROGRESS

### Outstanding craftsmanship.

The ratchet set with 1/4" and 1/2" external square drive is perfect for a wide range of precise, fine and coarse applications in industry and by tradesmen. The fine toothing enables precise work even in confined spaces, while the screwless FOD safety design ensures maximum safety.



PRODUCT IMAGE  
IN PROGRESS

### Simple switch function.

The recessed switching lever allows effortless directional change with just one hand and ensures maximum ease of use.



PRODUCT IMAGE  
IN PROGRESS

**Outstanding craftsmanship.**

The tool is forged from high-quality Chrome Alloy Steel, which gives it outstanding stability and resistance to continuous use. It is also chrome-plated for corrosion resistance.

**Technologies and features.**



**QuickRelease**

The QuickRelease safety lock prevents unintentional loss of insert tools. These click securely into place, and are only released again at the push of a button for a quick tool change. In transducers: The QuickRelease safety lock helps you to quickly mount and change transducers. The transducers lock into the calibration system and only unlock again at the push of the buttons.



**Foreign Object Damage**

STAHLWILLE protects against FOD (Foreign Object Damage). Our tool is ideal for safety-relevant sectors such as aviation, thanks to the screwless design.



**Fine-tooth ratchet mechanism**

Our fine-tooth ratchets with 80 teeth re-engage after just 4.5° for maximum precision in confined spaces. 8 pairs of parallel teeth simultaneously ensure maximum load-bearing capacity and particularly smooth running, even at high torques.



**2-component handle**

Our 2-component handle is non-slip and ergonomically designed. It is resistant to the most common oils, greases, fuels, brake fluids, and Skydrol.

**Technical attributes.**

Number of tools 2

**Logistics data.**

Depth mm (IFS) 310

Width mm (b)	90 mm	Width mm (IFS)	90
DIN	DIN 3122 / ISO 3315	Height mm (IFS)	40
Height mm (h)	40 mm	WEEE/ElektroG	nicht ear-pflichtig
Length mm (L)	310 mm	Length (packaged, mm)	310
		Width (packaged, mm)	90
		Height (packaging, mm)	40
		Volume (packaged, dm3)	1.116 dm3
		Product no.	91336421
		Weight (gross, kg)	0,808
		Weight PAP (kg)	0,030
		Weight PVC (kg)	0,010
		GTIN	4018754342914
		Country of origin AWR	GERMANY
		Region of origin	Nordrhein-Westfalen
		Customs tariff no.	82042000
		Packing standard	1
		Weight (g)	808 g

Parts list.



13111120	11111020
QR fine-tooth ratchet	QR fine-tooth ratchet

Variants.

Product no.	Model No. (ERP)	Description	GTIN
91336421	415QR/512QR Knarrensatz	QR fine tooth ratchet set 2	4018754342914

GTIN.



## Spare part(s), spare part(s) for.



19012020

Ratchet spare parts set



19040040

Ratchet spare parts set

## Images.

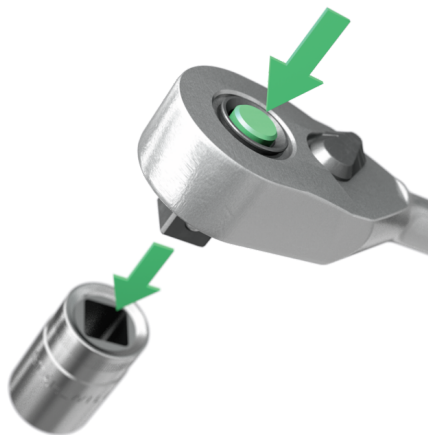

**STAHLWILLE Eduard Wille GmbH**

Lindenallee 27 · 42349 Wuppertal · Germany · Phone: +49 202 4791-0

info@stahlwille.de · www.stahlwille.com

© STAHLWILLE Eduard Wille GmbH, Wuppertal