



QuickRelease fine-tooth flexible-joint ratchet

416QR



Product no. 11261010
GTIN 4018754286362
Model 416QR



Label.

QR fine-tooth flexible ratchet 1/4 RSW.4.5° L.170mm

Properties.

- 1/4" external square drive
- reversible
- 80 teeth
- for working in tight spaces, with a working angle of just 4.5°
- with QuickRelease safety lock
- handle can be swivelled up and down by approximately 90°, engages and locks in the following positions: straight, 30° up, 60° up, 30° down
- easy release of the lock at the push of a button
- with 2-component handle
- FOD-preventive due to screwless design
- DBGM (German Federal Utility Model)
- Chrome Alloy Steel, chrome-plated
- DIN 3122 / ISO 3315

Benefits.

Reversible STAHLWILLE 1/4" fine-tooth ratchet with QR push button release.

Patented QuickRelease locking system secures every component from ratchet and the joint to the socket without loss of space.

The high-quality Chrome Alloy Steel construction promises a long service life.

80 teeth allow a practical working angle of just 4.5° - for even power transmission and precise use in the tightest spaces.

Ratchet head swivels 90°, lockable in 4 positions (0°; 30°/60° up; 30° down) - for hard-to-reach places.

Product highlights.



Simple and reliable switching function.

The recessed switch lever makes it easy to change directions, even with one hand.



For hard-to-reach work areas.

Our reversible ratchet with long force loading point is ideal for working on hard-to-reach screw points. It enables better power transmission when tightening screws.



Ideal for continuous use.

The ratchet is forged from high-quality Chrome Alloy Steel and additionally chrome-plated, which gives it high stability and resistance even in continuous use. It is designed for precise and safe continuous use in automotive or commercial vehicle workshops, assembly and industry.

Technologies and features.



QuickRelease

The QuickRelease safety lock prevents unintentional loss of insert tools. These click securely into place, and are only released again at the push of a button for a quick tool change. In transducers: The QuickRelease safety lock helps you to quickly mount and change transducers. The transducers lock into the calibration system and only unlock again at the push of the buttons.



Foreign Object Damage

STAHLWILLE protects against FOD (Foreign Object Damage). Our tool is ideal for safety-relevant sectors such as aviation, thanks to the screwless design.



Fine-tooth ratchet mechanism

Our fine-tooth ratchets with 80 teeth re-engage after just 4.5° for maximum precision in confined spaces. 8 pairs of parallel teeth simultaneously ensure maximum load-bearing capacity and particularly smooth running, even at high torques.

**2-component handle**

Our 2-component handle is non-slip and ergonomically designed. It is resistant to the most common oils, greases, fuels, brake fluids, and Skydrol.

Technical attributes.

a	12 mm
External square drive (inch)	1/4
Number of teeth	80
Working angle	4.5 °
Width mm (b)	22,5 mm
DIN	DIN 3122 / ISO 3315
Length mm (L)	170 mm
Alloy	Chrome Alloy Steel
Model No.	416QR

Logistics data.

Depth mm (IFS)	170
Width mm (IFS)	20
Height mm (IFS)	20
WEEE/ElektroG	nicht ear-pflichtig
Length (packaged, mm)	220
Width (packaged, mm)	30
Height (packaging, mm)	25
Volume (packaged, dm3)	0.165 dm3
Product no.	11261010
Weight (gross, kg)	0,130
Weight PAP (kg)	0,000
Weight PVC (kg)	0,004
GTIN	4018754286362
Country of origin AWR	GERMANY
Region of origin	Nordrhein-Westfalen
Customs tariff no.	82042000
Packing standard	1
Weight (g)	170 g

Variants.

Product no.	Model No. (ERP)	Description	GTIN
11261010	416QR	QR fine-tooth flexible ratchet 1/4 RSW.4.5° L.170mm	4018754286362

GTIN.



Accessories (for).



11180010
Bit holder



11030003
Square drive adaptor

Images.

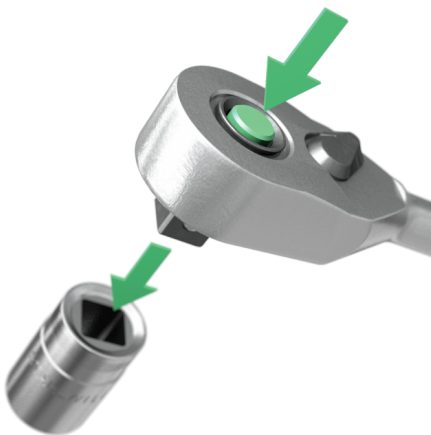

STAHLWILLE Eduard Wille GmbH

Lindenallee 27 · 42349 Wuppertal · Germany · Phone: +49 202 4791-0

info@stahlwille.de · www.stahlwille.com

© STAHLWILLE Eduard Wille GmbH, Wuppertal