



QuickRelease fine-tooth ratchet 1/4"

415QRL N

Product no.	11111040
GTIN	4018754283002
Model	415QRL N



Label.

QR fine-tooth ratchet 1/4 RSW.4.5° L.153mm

Properties.

- long version
- 1/4" external square drive
- reversible
- 80 teeth
- for working in tight spaces, with a working angle of just 4.5°
- with QuickRelease safety lock
- with 2-component handle
- FOD-preventive due to screwless design
- DBGM (German Federal Utility Model)
- Chrome Alloy Steel, chrome-plated
- DIN 3122 / ISO 3315

Benefits.

Made in Germany - reversible STAHLWILLE ratchet with 2-component handle, 80 teeth, QR push button release, length 153 mm, DIN 3122/ISO 3315, Chrome Alloy Steel, chrome-plated, 11111040.

Unique QR locking system - secures every component from ratchet to extension to socket without wasting space.

80 teeth allow for a working angle of only 4.5° - facilitating efficient working even in confined spaces.

Technologies and features.



QuickRelease

The QuickRelease safety lock prevents unintentional loss of insert tools. These click securely into place, and are only released again at the push of a button for a quick tool change. In transducers: The QuickRelease safety lock helps you to quickly mount and change transducers. The transducers lock into the calibration system and only unlock again at the push of the buttons.



Foreign Object Damage

STAHLWILLE protects against FOD (Foreign Object Damage). Our tool is ideal for safety-relevant sectors such as aviation, thanks to the screwless design.



Fine-tooth ratchet mechanism

Our fine-tooth ratchets with 80 teeth re-engage after just 4.5° for maximum precision in confined spaces. 8 pairs of parallel teeth simultaneously ensure maximum load-bearing capacity and particularly smooth running, even at high torques.

Technical attributes.

a	10,7 mm
External square drive (inch)	1/4
Number of teeth	80
Working angle	4.5 °
Width mm (b)	22,6 mm
DIN	DIN 3122 / ISO 3315
Length mm (L)	153 mm
Alloy	Chrome Alloy Steel

Logistics data.

Depth mm (IFS)	153
Width mm (IFS)	23
Height mm (IFS)	22
WEEE/ElektroG	nicht ear-pflichtig
Length (packaged, mm)	200
Width (packaged, mm)	105
Height (packaging, mm)	22
Volume (packaged, dm3)	0.462 dm3
Product no.	11111040
Weight (gross, kg)	0,104
Weight PAP (kg)	0,000
Weight PVC (kg)	0,004
GTIN	4018754283002
Country of origin AWR	GERMANY
Region of origin	Nordrhein-Westfalen
Customs tariff no.	82042000

Packing standard	1
Weight (g)	94 g

Variants.

Product no.	Model No. (ERP)	Description	GTIN
11111040	415QRL N	QR fine-tooth ratchet 1/4 RSW.4.5° L.153mm	4018754283002

GTIN.



Accessories (for).



19012020
Ratchet spare parts set



11180010
Bit holder



11030003
Square drive adaptor

Spare part(s), spare part(s) for.



19012020
Ratchet spare parts set

Images.

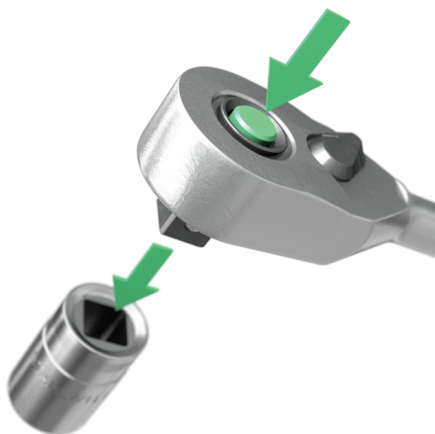

STAHLWILLE Eduard Wille GmbH

Lindenallee 27 · 42349 Wuppertal · Germany · Phone: +49 202 4791-0

info@stahlwille.de · www.stahlwille.com

© STAHLWILLE Eduard Wille GmbH, Wuppertal