

VDE screwdriver socket

12174 VDE



Product no. 02390030
GTIN 4018754253616
Model 12174 VDE T 30



Label. 3/8 " VDE screwdriver socket L.67mm

Features.

- for internal TORX® screws
- Chrome-Alloy-Steel, chrome plated
- VDE insulated up to 1000 V
- DIN EN 60900
- #T; AC/1000 V

Advantages.

For recessed TORX® screws

Technical Drawing.

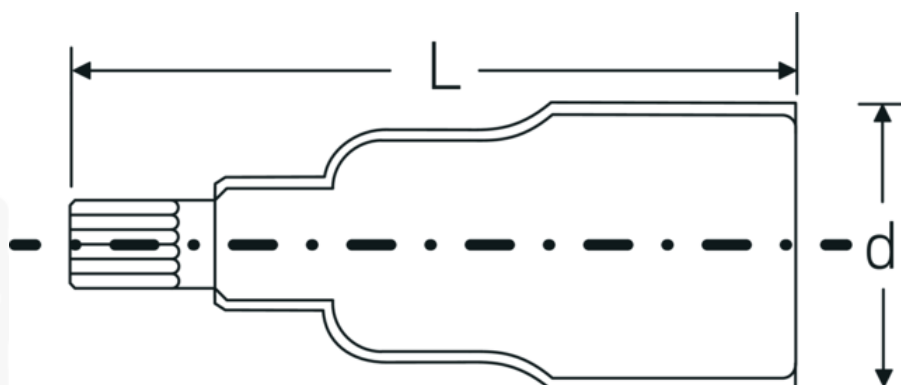

Technical Attributes.

Drive profile	TORX®
Internal square drive (inch)	3/8 "
d	22,8 mm
DIN	DIN EN 60900
Size of output profile	T30
Length mm (L)	67 mm

Logistics data.

Depth mm (IFS)	66
Width mm (IFS)	19
Height mm (IFS)	19
Length (packed, mm)	75
Width (packed, mm)	35
Height (packed, mm)	35
Volume (packed, dm3)	0.091875 dm3
Art. no.	02390030
Weight (gross, kg)	0,055
Weight PAP (kg)	0,000
Weight PVC (kg)	0,002
GTIN	4018754253616
Country of origin	GERMANY
Region of origin	Nordrhein-Westfalen
WEEE/ElektroG	nicht ear-pflichtig
Customs tariff no.	82042000
Packing standard	1
Weight	54 g

Variants.

Art. no.	Model no. (ERP)	Description	GTIN
02390020	12174 VDE T 20	3/8 " VDE screwdriver socket L.67mm	4018754253593
02390025	12174 VDE T 25	3/8 " VDE screwdriver socket L.67mm	4018754253609
02390030	12174 VDE T 30	3/8 " VDE screwdriver socket L.67mm	4018754253616
02390040	12174 VDE T 40	3/8 " VDE screwdriver socket L.67mm	4018754253623
02390045	12174 VDE T 45	3/8 " VDE screwdriver socket L.67mm	4018754253630

GTIN-Code.





STAHLWILLE Eduard Wille GmbH & Co. KG

Lindenallee 27 · 42349 Wuppertal · Germany · Phone: +49 202 4791-0 · Fax: +49 202 4791-200
info@stahlwille.de · www.stahlwille.com · Copyright by STAHLWILLE Eduard Wille GmbH & Co. KG, Wuppertal
Copyright by STAHLWILLE Eduard Wille GmbH & Co. KG, Wuppertal