

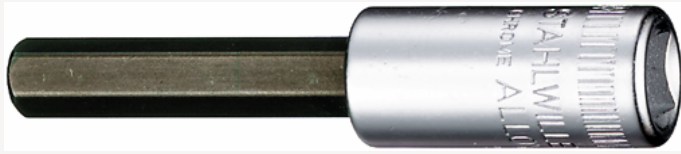

INHEX screwdriver sockets 1/4", inch

44a



Product no. **01450006**
GTIN **4018754126903**
Model **44 A 3/32**



Label. INHEX screwdriver socket 1/4 " 3/32 L.55mm

Technical Drawing.

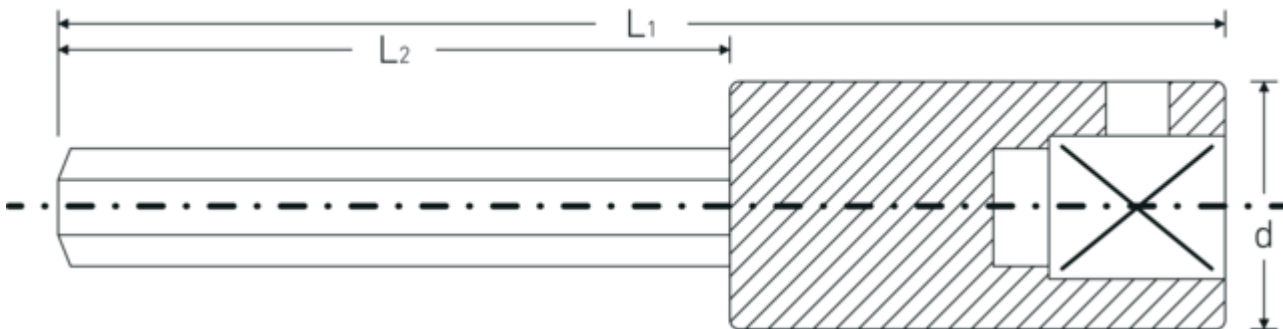

Technical Attributes.

Drive profile	hex
External hex drive (inch)	3/32
Internal square drive (inch)	1/4 "
d	10,7 mm
DIN	DIN 7422
L1	55 mm
L2	30 mm

Logistics data.

Depth mm (IFS)	55
Width mm (IFS)	11
Height mm (IFS)	11
Length (packed, mm)	100
Width (packed, mm)	60
Height (packed, mm)	11
Volume (packed, dm ³)	0.066 dm ³
Product no.	01450006
Weight (gross, kg)	0,074
Weight PAP (kg)	0,000

Weight PVC (kg)	0,003
GTIN	4018754126903
Country of origin	GERMANY
Region of origin	Nordrhein-Westfalen
WEEE/ElektroG	nicht ear-pflichtig
Customs tariff no.	82042000
Packing standard	5
Weight	14 g

Variants.

Product no.	Model no. (ERP)	Description	GTIN
01450004	44 A 1/16	INHEX screwdriver socket 1/4 " 1/16 L.55mm	4018754126880
01450005	44 A 5/64	INHEX screwdriver socket 1/4 " 5/64 L.55mm	4018754126897
01450006	44 A 3/32	INHEX screwdriver socket 1/4 " 3/32 L.55mm	4018754126903
01450007	44 A 7/64	INHEX screwdriver socket 1/4 " 7/64 L.55mm	4018754126910
01450008	44 A 1/8	INHEX screwdriver socket 1/4 " 1/8 L.55mm	4018754001439
01450009	44 A 9/64	INHEX screwdriver socket 1/4 " 9/64 L.55mm	4018754126927
01450010	44 A 5/32	INHEX screwdriver socket 1/4 " 5/32 L.55mm	4018754001446
01450012	44 A 3/16	INHEX screwdriver socket 1/4 " 3/16 L.55mm	4018754126934
01450014	44 A 7/32	INHEX screwdriver socket 1/4 " 7/32 L.55mm	4018754126941
01450016	44 A 1/4	INHEX screwdriver socket 1/4 " 1/4 L.55mm	4018754126958

GTIN-Code.

