



Socket

46a



Product no. **02420032**
GTIN **4018754004331**
Model **46 A 1/2**



Label. 3/8 " Socket Spanner size 1/2" L.54mm

- Features.**
- Long
 - ASME B 107.1, Fed. Spec. GGG-W-641, SAE AS 954-E
 - HPQ® heavy-duty steel, chrome-plated

Advantages.

Long

Technical Drawing.

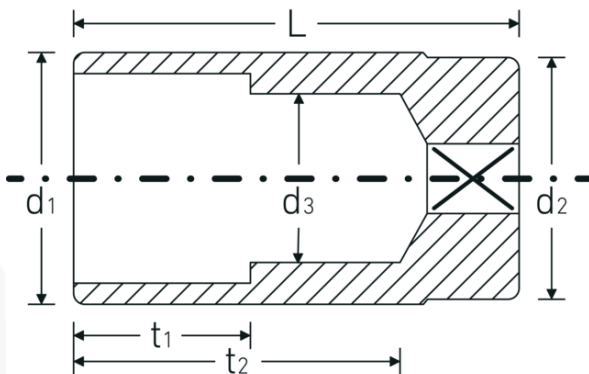

Technical Attributes.

Drive profile bi-hex AS-Drive®

Logistics data.

Depth mm (IFS) 54

Internal square drive (inch)	3/8 "	Width mm (IFS)	19
d1	18 mm	Height mm (IFS)	19
d2	17,5 mm	Length (packed, mm)	95
d3	11,5 mm	Width (packed, mm)	58
Length mm (L)	54 mm	Height (packed, mm)	20
Spanner size [inch]	1/2 "	Volume (packed, dm3)	0.1102 dm3
t1	20 mm	Art. no.	02420032
t2	40,2 mm	Weight (gross, kg)	0,290
		Weight PAP (kg)	0,000
		Weight PVC (kg)	0,003
		GTIN	4018754004331
		Country of origin	GERMANY
		Region of origin	Nordrhein-Westfalen
		WEEE/ElektroG	nicht ear-pflichtig
		Customs tariff no.	82042000
		Packing standard	5
		Weight	64 g

Variants.

Art. no.	Model no. (ERP)	Description	GTIN
02420016	46 A 1/4	3/8 " Socket Spanner size 1/4" L.54mm	4018754127009
02420020	46 A 5/16	3/8 " Socket Spanner size 5/16" L.54mm	4018754127016
02420022	46 A 11/32	3/8 " Socket Spanner size 11/32" L.54mm	4018754286232
02420024	46 A 3/8	3/8 " Socket Spanner size 3/8" L.54mm	4018754004317
02420028	46 A 7/16	3/8 " Socket Spanner size 7/16" L.54mm	4018754004324
02420032	46 A 1/2	3/8 " Socket Spanner size 1/2" L.54mm	4018754004331
02420034	46 A 9/16	3/8 " Socket Spanner size 9/16" L.60mm	4018754004348
02420035	46 A 19/32	3/8 " Socket Spanner size 19/32" L.60mm	4018754004355
02420036	46 A 5/8	3/8 " Socket Spanner size 5/8" L.60mm	4018754004362
02420038	46 A 11/16	3/8 " Socket Spanner size 11/16" L.65mm	4018754004379
02420040	46 A 3/4	3/8 " Socket Spanner size 3/4" L.65mm	4018754004386
02420042	46 A 13/16	3/8 " Socket Spanner size 13/16" L.65mm	4018754127023
02420044	46 A 7/8	3/8 " Socket Spanner size 7/8" L.65mm	4018754004393
02420046	46 A 15/16	3/8 " Socket Spanner size 15/16" L.65mm	4018754127030
02420048	46 A 1	3/8 " Socket Spanner size 1" L.65mm	4018754127047

GTIN-Code.



STAHLWILLE Eduard Wille GmbH & Co. KG

Lindenallee 27 · 42349 Wuppertal · Germany · Phone: +49 202 4791-0 · Fax: +49 202 4791-200
info@stahlwille.de · www.stahlwille.com · Copyright by STAHLWILLE Eduard Wille GmbH & Co. KG, Wuppertal
Copyright by STAHLWILLE Eduard Wille GmbH & Co. KG, Wuppertal