



## Socket

456

Product no. 02110008  
GTIN 4018754002894  
Model 456 8



**Label.** 3/8 " Socket Spanner size 8mm L.25mm

**Features.**

- DIN 3124/ISO 2725-1, ASME B 107.5M, DIN EN 3709 (test loads)
- HPQ® high performance steel, chrome plated

## Advantages.

DIN 3124/ISO 2725-1, ASME B 107.5M, E DIN EN 3709 (test values).

## Technical Drawing.

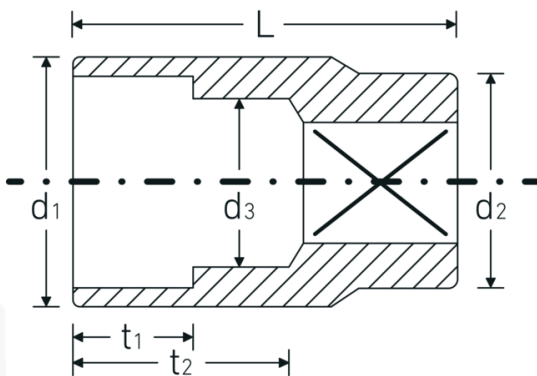

## Technical Attributes.

Drive profile hex AS-Drive®  
Internal square drive (inch) 3/8 "

## Logistics data.

Depth mm (IFS) 23  
Width mm (IFS) 17

|                                |   |                             |                     |
|--------------------------------|---|-----------------------------|---------------------|
| <b>d1</b>                      | 11,7 mm   | <b>Height mm (IFS)</b>      | 17                  |
| <b>d2</b>                      | 16,5 mm   | <b>Length (packed, mm)</b>  | 86                  |
| <b>d3</b>                      | 7 mm  | <b>Width (packed, mm)</b>   | 35                  |
| <b>DIN</b>                     | DIN 3124 / ISO<br>2725-1, ASME B<br>107.5M, DIN EN 3709 | <b>Height (packed, mm)</b>  | 24                  |
|                                |   | <b>Volume (packed, dm3)</b> | 0.07224 dm3         |
| <b>Length mm (L)</b>           | 25 mm   | <b>Art. no.</b>             | 02110008            |
| <b>Width across flats [mm]</b> | 8 mm  | <b>Weight (gross, kg)</b>   | 0,190               |
| <b>t1</b>                      | 7 mm  | <b>Weight PAP (kg)</b>      | 0,000               |
| <b>t2</b>                      | 13,5 mm   | <b>Weight PVC (kg)</b>      | 0,003               |
|                                |   | <b>GTIN</b>                 | 4018754002894       |
|                                |   | <b>Country of origin</b>    | GERMANY             |
|                                |   | <b>Region of origin</b>     | Nordrhein-Westfalen |
|                                |   | <b>WEEE/ElektroG</b>        | nicht ear-pflichtig |
|                                |   | <b>Customs tariff no.</b>   | 82042000            |
|                                |   | <b>Packing standard</b>     | 10                  |
|                                |   | <b>Weight</b>               | 19 g                |

## Variants.

| Art. no. | Model no. (ERP) | Description                           | GTIN          |
|----------|-----------------|---------------------------------------|---------------|
| 02110007 | 456 7           | 3/8 " Socket Spanner size 7mm L.24mm  | 4018754002887 |
| 02110008 | 456 8           | 3/8 " Socket Spanner size 8mm L.25mm  | 4018754002894 |
| 02110009 | 456 9           | 3/8 " Socket Spanner size 9mm L.25mm  | 4018754002900 |
| 02110010 | 456 10          | 3/8 " Socket Spanner size 10mm L.27mm | 4018754002917 |
| 02110011 | 456 11          | 3/8 " Socket Spanner size 11mm L.27mm | 4018754002924 |
| 02110012 | 456 12          | 3/8 " Socket Spanner size 12mm L.28mm | 4018754002931 |
| 02110013 | 456 13          | 3/8 " Socket Spanner size 13mm L.30mm | 4018754002948 |
| 02110014 | 456 14          | 3/8 " Socket Spanner size 14mm L.30mm | 4018754002955 |
| 02110015 | 456 15          | 3/8 " Socket Spanner size 15mm L.31mm | 4018754002962 |
| 02110016 | 456 16          | 3/8 " Socket Spanner size 16mm L.31mm | 4018754002979 |
| 02110017 | 456 17          | 3/8 " Socket Spanner size 17mm L.31mm | 4018754002986 |
| 02110018 | 456 18          | 3/8 " Socket Spanner size 18mm L.32mm | 4018754002993 |
| 02110019 | 456 19          | 3/8 " Socket Spanner size 19mm L.32mm | 4018754003006 |
| 02110020 | 456 20          | 3/8 " Socket Spanner size 20mm L.34mm | 4018754003013 |
| 02110021 | 456 21          | 3/8 " Socket Spanner size 21mm L.34mm | 4018754003020 |
| 02110022 | 456 22          | 3/8 " Socket Spanner size 22mm L.35mm | 4018754003037 |

## GTIN-Code.



**STAHLWILLE Eduard Wille GmbH & Co. KG**

Lindenallee 27 · 42349 Wuppertal · Germany · Phone: +49 202 4791-0 · Fax: +49 202 4791-200  
info@stahlwille.de · www.stahlwille.com · Copyright by STAHLWILLE Eduard Wille GmbH & Co. KG, Wuppertal  
Copyright by STAHLWILLE Eduard Wille GmbH & Co. KG, Wuppertal