

## Sockets 3/8"

### 45aSP



Product no. **02011014**  
GTIN **4018754109159**  
Model **45A SP 14 = 7/16**



**Label.** 3/8 " Socket Wrench size 7/16" L.28mm

## Technologies and features.



### High Performance Quality (HPQ®)

Our HPQ® tool is made of wear-resistant high-performance steel, yet is thin-walled and lightweight. It withstands high torques and is ideal for work in confined spaces such as turbines.

## Technical Drawing.

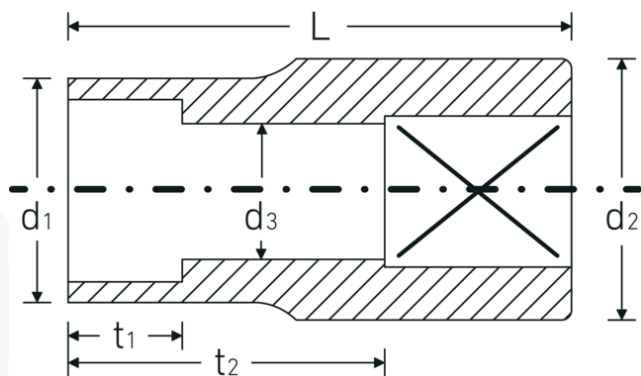

## Technical Attributes.

Drive profile	Spline-Drive
Internal square drive (inch)	3/8 "
d1	16 mm
d2	17,3 mm
d3	10,4 mm
Size of output profile	14
Length mm (L)	28 mm
Wrench size [inch]	7/16 "
t1	11 mm
t2	14,5 mm

## Logistics data.

Depth mm (IFS)	27
Width mm (IFS)	18
Height mm (IFS)	18
Length (packed, mm)	27
Width (packed, mm)	18
Height (packed, mm)	18
Volume (packed, dm3)	0.008748 dm3
Product no.	02011014
Weight (gross, kg)	0,037
Weight PAP (kg)	0,000
Weight PVC (kg)	0,002
GTIN	4018754109159
Country of origin	GERMANY
Region of origin	Nordrhein-Westfalen
WEEE/ElektroG	nicht ear-pflichtig
Customs tariff no.	82042000
Packing standard	1
Weight	37 g

## Variants.

Product no.	Model no. (ERP)	Description	GTIN
02011012	45A SP 12 = 3/8	3/8 " Socket Wrench size 3/8" L.26,5mm	4018754109142
02011014	45A SP 14 = 7/16	3/8 " Socket Wrench size 7/16" L.28mm	4018754109159
02011016	45A SP 16 = 1/2	3/8 " Socket Wrench size 1/2" L.28mm	4018754109166

## GTIN-Code.



