

## Sockets

### 40TX



Product no. **01270005**  
GTIN **4018754000944**  
Model **40 TX E 5**



**Label.** 1/4 " Sockets L.23mm

**Features.**

- for external TORX® screws
- HPQ® high performance steel, chrome plated

## Advantages.

For external TORX® screws.

## Technologies and features.



### High Performance Quality (HPQ®)

Our HPQ® tool is made of wear-resistant high-performance steel, yet is thin-walled and lightweight. It withstands high torques and is ideal for work in confined spaces such as turbines.

## Technical Drawing.

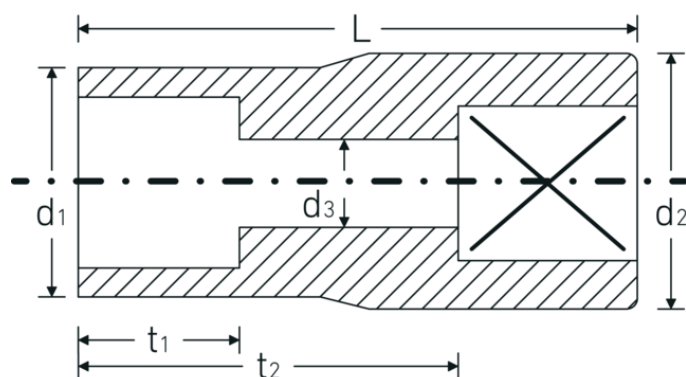

## Technical Attributes.

Drive profile	TORX®
Internal square drive (inch)	1/4 "
d1	6,7 mm
d2	10,7 mm
d3	2,8 mm
Size of output profile	E5
Length mm (L)	23 mm
t1	5 mm
t2	15 mm

## Logistics data.

Depth mm (IFS)	25
Width mm (IFS)	11
Height mm (IFS)	11
Length (packed, mm)	75
Width (packed, mm)	50
Height (packed, mm)	11
Volume (packed, dm <sup>3</sup> )	0.04125 dm <sup>3</sup>
Art. no.	01270005
Weight (gross, kg)	0,075
Weight PAP (kg)	0,000
Weight PVC (kg)	0,002
GTIN	4018754000944
Country of origin	GERMANY
Region of origin	Nordrhein-Westfalen
WEEE/ElektroG	nicht ear-pflichtig
Customs tariff no.	82042000
Packing standard	10
Weight	7 g

## Variants.

Art. no.	Model no. (ERP)	Description	GTIN
01270004	40 TX E 4	1/4 " Sockets L.23mm	4018754000937
01270005	40 TX E 5	1/4 " Sockets L.23mm	4018754000944
01270006	40 TX E 6	1/4 " Sockets L.23mm	4018754000951

01270007	40 TX E 7	1/4 " Sockets L.23mm	4018754000968
01270008	40 TX E 8	1/4 " Sockets L.23mm	4018754000975
01270010	40 TX E 10	1/4 " Sockets L.23mm	4018754000982

## GTIN-Code.



### **STAHLWILLE Eduard Wille GmbH & Co. KG**

Lindenallee 27 · 42349 Wuppertal · Germany · Phone: +49 202 4791-0 · Fax: +49 202 4791-200  
info@stahlwille.de · www.stahlwille.com · Copyright by STAHLWILLE Eduard Wille GmbH & Co. KG, Wuppertal  
Copyright by STAHLWILLE Eduard Wille GmbH & Co. KG, Wuppertal