



Sockets 3/4", metric

40D

Product no. 01030014
GTIN 4018754000395
Model 40 D 14



Label. 1/4 " Socket Wrench size 14mm L.24mm

Technologies and features.



High Performance Quality (HPQ®)

Our HPQ® tool is made of wear-resistant high-performance steel, yet is thin-walled and lightweight. It withstands high torques and is ideal for work in confined spaces such as turbines.

Technical Drawing.

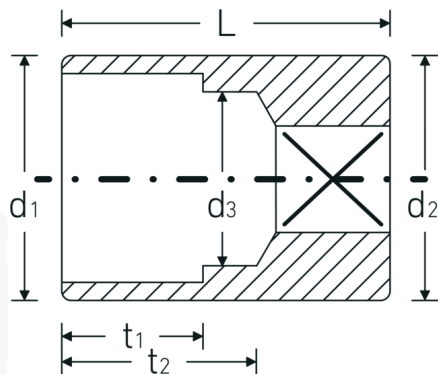

Technical Attributes.

Drive profile	bi-hex AS-Drive®
Internal square drive (inch)	1/4 "
d1	18,8 mm
d2	18,8 mm
d3	13 mm
DIN	DIN 3124 / ISO 2725-1, DIN EN 3709, ASME B 107.5M
Length mm (L)	24 mm
Width across flats [mm]	14 mm
t1	10 mm
t2	14,7 mm

Logistics data.

Depth mm (IFS)	24
Width mm (IFS)	20
Height mm (IFS)	20
Length (packed, mm)	100
Width (packed, mm)	55
Height (packed, mm)	20
Volume (packed, dm3)	0.11 dm3
Product no.	01030014
Weight (gross, kg)	0,326
Weight PAP (kg)	0,000
Weight PVC (kg)	0,005
GTIN	4018754000395
Country of origin	GERMANY
Region of origin	Nordrhein-Westfalen
WEEE/ElektroG	nicht ear-pflichtig
Customs tariff no.	82042000
Packing standard	10
Weight	30 g

Variants.

Product no.	Model no. (ERP)	Description	GTIN
01030005	40 D 5	1/4 " Socket Wrench size 5mm L.23mm	4018754000302
01030006	40 D 6	1/4 " Socket Wrench size 6mm L.23mm	4018754000319
01030007	40 D 7	1/4 " Socket Wrench size 7mm L.23mm	4018754000326
01030008	40 D 8	1/4 " Socket Wrench size 8mm L.23mm	4018754000333
01030009	40 D 9	1/4 " Socket Wrench size 9mm L.23mm	4018754000340
01030010	40 D 10	1/4 " Socket Wrench size 10mm L.23mm	4018754000357
01030011	40 D 11	1/4 " Socket Wrench size 11mm L.23mm	4018754000364
01030012	40 D 12	1/4 " Socket Wrench size 12mm L.23mm	4018754000371
01030013	40 D 13	1/4 " Socket Wrench size 13mm L.23mm	4018754000388
01030014	40 D 14	1/4 " Socket Wrench size 14mm L.24mm	4018754000395
01030055	40 D 5,5	1/4 " Socket Wrench size 5,5mm L.23mm	4018754000401

GTIN-Code.

