

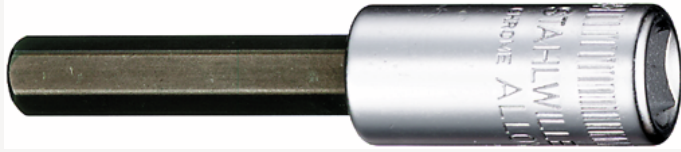

## INHEX screwdriver sockets 1/4", inch

44a



Product no. **01450005**  
GTIN **4018754126897**  
Model **44 A 5/64**



**Label.** INHEX screwdriver socket 1/4 " 5/64 L.55mm

### Technical Drawing.

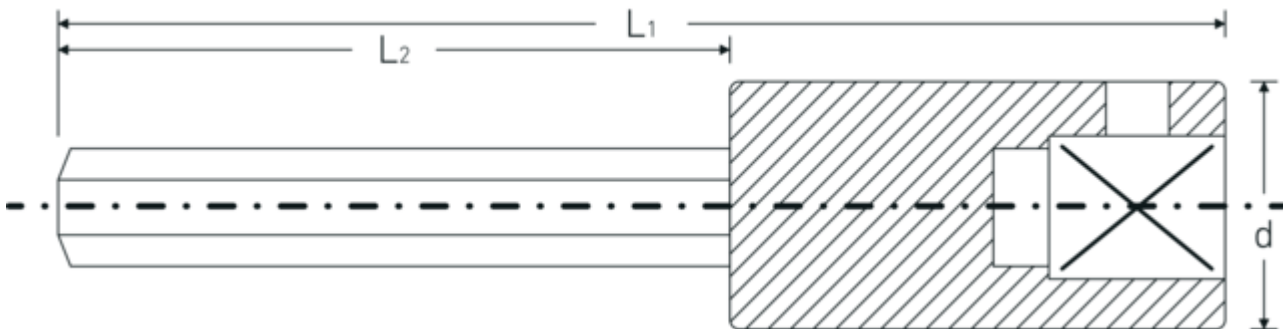

### Technical Attributes.

Drive profile	hex
External hex drive (inch)	5/64
Internal square drive (inch)	1/4 "
d	10,7 mm
DIN	DIN 7422
L1	55 mm
L2	30 mm

### Logistics data.

Depth mm (IFS)	55
Width mm (IFS)	11
Height mm (IFS)	11
Length (packed, mm)	100
Width (packed, mm)	60
Height (packed, mm)	11
Volume (packed, dm <sup>3</sup> )	0.066 dm <sup>3</sup>
Product no.	01450005
Weight (gross, kg)	0,063
Weight PAP (kg)	0,000

<b>Weight PVC (kg)</b>	0,003
<b>GTIN</b>	4018754126897
<b>Country of origin</b>	GERMANY
<b>Region of origin</b>	Nordrhein-Westfalen
<b>WEEE/ElektroG</b>	nicht ear-pflichtig
<b>Customs tariff no.</b>	82042000
<b>Packing standard</b>	5
<b>Weight</b>	12 g

## Variants.

Product no.	Model no. (ERP)	Description	GTIN
01450004	44 A 1/16	INHEX screwdriver socket 1/4 " 1/16 L.55mm	4018754126880
01450005	44 A 5/64	INHEX screwdriver socket 1/4 " 5/64 L.55mm	4018754126897
01450006	44 A 3/32	INHEX screwdriver socket 1/4 " 3/32 L.55mm	4018754126903
01450007	44 A 7/64	INHEX screwdriver socket 1/4 " 7/64 L.55mm	4018754126910
01450008	44 A 1/8	INHEX screwdriver socket 1/4 " 1/8 L.55mm	4018754001439
01450009	44 A 9/64	INHEX screwdriver socket 1/4 " 9/64 L.55mm	4018754126927
01450010	44 A 5/32	INHEX screwdriver socket 1/4 " 5/32 L.55mm	4018754001446
01450012	44 A 3/16	INHEX screwdriver socket 1/4 " 3/16 L.55mm	4018754126934
01450014	44 A 7/32	INHEX screwdriver socket 1/4 " 7/32 L.55mm	4018754126941
01450016	44 A 1/4	INHEX screwdriver socket 1/4 " 1/4 L.55mm	4018754126958

## GTIN-Code.

