



Sockets 3/8", metric

456

Product no. **02110015**
GTIN **4018754002962**
Model **456 15**



Label. 3/8 " Socket Wrench size 15mm L.31mm

Technical Drawing.

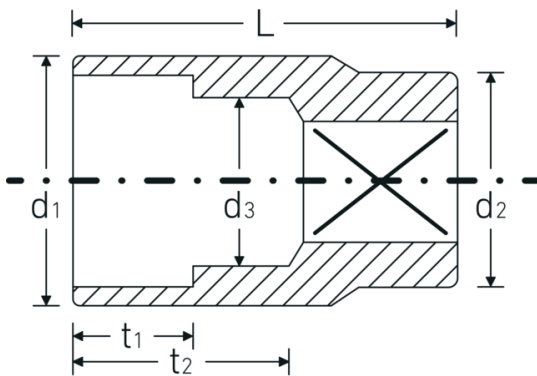

Technical Attributes.

Drive profile	hex AS-Drive®
Internal square drive (inch)	3/8 "
d1	20,6 mm
d2	19 mm
d3	14 mm
DIN	DIN 3124 / ISO 2725-1, ASME B 107.5M, DIN EN 3709
Length mm (L)	31 mm
Width across flats [mm]	15 mm

Logistics data.

Depth mm (IFS)	25
Width mm (IFS)	21
Height mm (IFS)	21
Length (packed, mm)	106
Width (packed, mm)	43
Height (packed, mm)	26
Volume (packed, dm ³)	0.118508 dm ³
Product no.	02110015
Weight (gross, kg)	0,405

t1	12,5 mm	Weight PAP (kg)	0,000
t2	19,2 mm	Weight PVC (kg)	0,005
		GTIN	4018754002962
		Country of origin	GERMANY
		Region of origin	Nordrhein-Westfalen
		WEEE/ElektroG	nicht ear-pflichtig
		Customs tariff no.	82042000
		Packing standard	10
		Weight	30 g

Variants.

Product no.	Model no. (ERP)	Description	GTIN
02110007	456 7	3/8 " Socket Wrench size 7mm L.24mm	4018754002887
02110008	456 8	3/8 " Socket Wrench size 8mm L.25mm	4018754002894
02110009	456 9	3/8 " Socket Wrench size 9mm L.25mm	4018754002900
02110010	456 10	3/8 " Socket Wrench size 10mm L.27mm	4018754002917
02110011	456 11	3/8 " Socket Wrench size 11mm L.27mm	4018754002924
02110012	456 12	3/8 " Socket Wrench size 12mm L.28mm	4018754002931
02110013	456 13	3/8 " Socket Wrench size 13mm L.30mm	4018754002948
02110014	456 14	3/8 " Socket Wrench size 14mm L.30mm	4018754002955
02110015	456 15	3/8 " Socket Wrench size 15mm L.31mm	4018754002962
02110016	456 16	3/8 " Socket Wrench size 16mm L.31mm	4018754002979
02110017	456 17	3/8 " Socket Wrench size 17mm L.31mm	4018754002986
02110018	456 18	3/8 " Socket Wrench size 18mm L.32mm	4018754002993
02110019	456 19	3/8 " Socket Wrench size 19mm L.32mm	4018754003006
02110020	456 20	3/8 " Socket Wrench size 20mm L.34mm	4018754003013
02110021	456 21	3/8 " Socket Wrench size 21mm L.34mm	4018754003020
02110022	456 22	3/8 " Socket Wrench size 22mm L.35mm	4018754003037

GTIN-Code.



