



Sockets 1/2", metric, extra deep

51



Product no. **03020015**
GTIN **4018754005598**
Model **51 15**



Label. 1/2 " Socket Wrench size mm L.83mm

Technical Drawing.

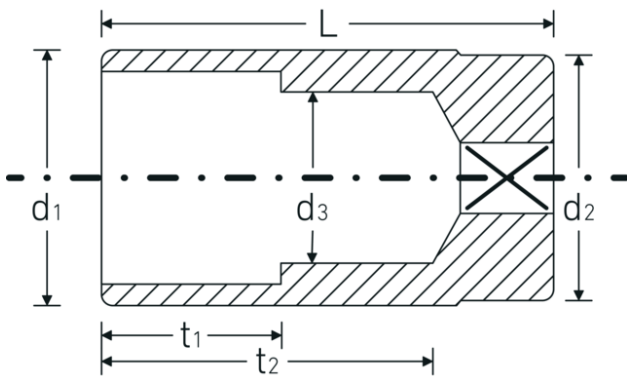

Technical Attributes.

Drive profile	bi-hex AS-Drive®
Internal square drive (inch)	1/2 "
d1	21,2 mm
d2	22,7 mm
d3	14 mm
DIN	DIN 3124 / ISO 2725-1, DIN EN 3710, DIN EN 3709, ASME B 107.5M
Length mm (L)	83 mm

Logistics data.

Depth mm (IFS)	83
Width mm (IFS)	23
Height mm (IFS)	23
Length (packed, mm)	120
Width (packed, mm)	85
Height (packed, mm)	48
Volume (packed, dm3)	0.4896 dm3
Product no.	03020015
Weight (gross, kg)	1,240

Width across flats [mm]	15 mm	Weight PAP (kg)	0,000
t1	35 mm	Weight PVC (kg)	0,008
t2	64,9 mm	GTIN	4018754005598
		Country of origin	GERMANY
		Region of origin	Nordrhein-Westfalen
		WEEE/ElektroG	nicht ear-pflichtig
		Customs tariff no.	82042000
		Packing standard	10
		Weight	125 g

Variants.

Product no.	Model no. (ERP)	Description	GTIN
03020010	51 10	1/2 " Socket Wrench size mm L.83mm	4018754167678
03020013	51 13	1/2 " Socket Wrench size mm L.83mm	4018754005574
03020014	51 14	1/2 " Socket Wrench size mm L.83mm	4018754005581
03020015	51 15	1/2 " Socket Wrench size mm L.83mm	4018754005598
03020016	51 16	1/2 " Socket Wrench size mm L.83mm	4018754005604
03020216	51 16-5/8	1/2 " Socket Wrench size mm/" L.83mm	4018754005741
03020017	51 17	1/2 " Socket Wrench size mm L.83mm	4018754005611
03020018	51 18	1/2 " Socket Wrench size mm L.83mm	4018754005628
03020019	51 19	1/2 " Socket Wrench size mm L.83mm	4018754005635
03020208	51 20,8-13/16	1/2 " Socket Wrench size mm/" L.83mm	4018754005734
03020021	51 21	1/2 " Socket Wrench size mm L.83mm	4018754005642
03020022	51 22	1/2 " Socket Wrench size mm L.83mm	4018754005659
03020024	51 24	1/2 " Socket Wrench size mm L.83mm	4018754005673
03020026	51 26	1/2 " Socket Wrench size mm L.83mm	4018754005680
03020027	51 27	1/2 " Socket Wrench size mm L.83mm	4018754005697
03020030	51 30	1/2 " Socket Wrench size mm L.83mm	4018754005710
03020032	51 32	1/2 " Socket Wrench size mm L.83mm	4018754005727

GTIN-Code.



4 018754 005598

