

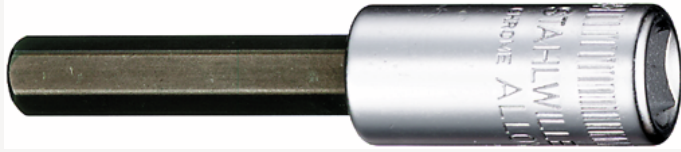

INHEX screwdriver sockets 1/4", metric

44



Product no. **01050004**
GTIN **4018754000487**
Model **44 4**



Label. INHEX screwdriver socket 1/4 " 4mm L.55mm

Technical Drawing.

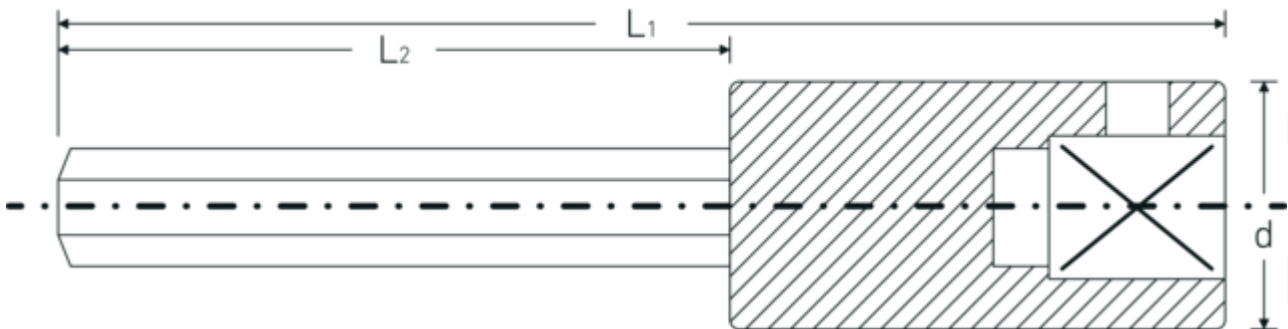

Technical Attributes.

| | |
|------------------------------|----------|
| Drive profile | hex |
| External hex drive (mm) | 4 mm |
| Internal square drive (inch) | 1/4 " |
| d | 10,7 mm |
| DIN | DIN 7422 |
| L1 | 55 mm |
| L2 | 30 mm |

Logistics data.

| | |
|-----------------------------------|------------------------|
| Depth mm (IFS) | 55 |
| Width mm (IFS) | 11 |
| Height mm (IFS) | 11 |
| Length (packed, mm) | 80 |
| Width (packed, mm) | 45 |
| Height (packed, mm) | 12 |
| Volume (packed, dm ³) | 0.0432 dm ³ |
| Product no. | 01050004 |
| Weight (gross, kg) | 0,075 |
| Weight PAP (kg) | 0,000 |

| | |
|---------------------------|---------------------|
| Weight PVC (kg) | 0,002 |
| GTIN | 4018754000487 |
| Country of origin | GERMANY |
| Region of origin | Nordrhein-Westfalen |
| WEEE/ElektroG | nicht ear-pflichtig |
| Customs tariff no. | 82042000 |
| Packing standard | 5 |
| Weight | 20 g |

Variants.

| Product no. | Model no. (ERP) | Description | GTIN |
|-------------|-----------------|---|---------------|
| 01050025 | 44 2,5 | INHEX screwdriver socket 1/4 " 2,5mm L.55mm | 4018754344000 |
| 01050003 | 44 3 | INHEX screwdriver socket 1/4 " 3mm L.55mm | 4018754000470 |
| 01050004 | 44 4 | INHEX screwdriver socket 1/4 " 4mm L.55mm | 4018754000487 |
| 01050005 | 44 5 | INHEX screwdriver socket 1/4 " 5mm L.55mm | 4018754000494 |
| 01050006 | 44 6 | INHEX screwdriver socket 1/4 " 6mm L.55mm | 4018754000500 |

GTIN-Code.

