



Sockets 3/8", metric

456

Product no. 02110008
GTIN 4018754002894
Model 456 8



Label. 3/8 " Socket Wrench size 8mm L.25mm

Technical Drawing.

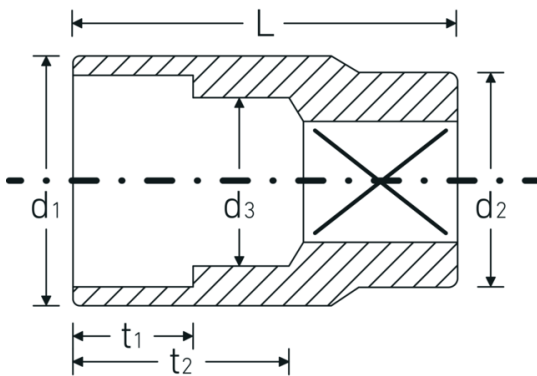

Technical Attributes.

| | |
|------------------------------|---|
| Drive profile | hex AS-Drive® |
| Internal square drive (inch) | 3/8 " |
| d1 | 11,7 mm |
| d2 | 16,5 mm |
| d3 | 7 mm |
| DIN | DIN 3124 / ISO 2725-1, ASME B 107.5M, DIN EN 3709 |
| Length mm (L) | 25 mm |
| Width across flats [mm] | 8 mm |

Logistics data.

| | |
|-----------------------------------|-------------------------|
| Depth mm (IFS) | 23 |
| Width mm (IFS) | 17 |
| Height mm (IFS) | 17 |
| Length (packed, mm) | 86 |
| Width (packed, mm) | 35 |
| Height (packed, mm) | 24 |
| Volume (packed, dm ³) | 0.07224 dm ³ |
| Product no. | 02110008 |
| Weight (gross, kg) | 0,190 |

| | | | |
|----|---------|---------------------------|---------------------|
| t1 | 7 mm | Weight PAP (kg) | 0,000 |
| t2 | 13,5 mm | Weight PVC (kg) | 0,003 |
| | | GTIN | 4018754002894 |
| | | Country of origin | GERMANY |
| | | Region of origin | Nordrhein-Westfalen |
| | | WEEE/ElektroG | nicht ear-pflichtig |
| | | Customs tariff no. | 82042000 |
| | | Packing standard | 10 |
| | | Weight | 19 g |

Variants.

| Product no. | Model no. (ERP) | Description | GTIN |
|-------------|-----------------|--------------------------------------|---------------|
| 02110007 | 456 7 | 3/8 " Socket Wrench size 7mm L.24mm | 4018754002887 |
| 02110008 | 456 8 | 3/8 " Socket Wrench size 8mm L.25mm | 4018754002894 |
| 02110009 | 456 9 | 3/8 " Socket Wrench size 9mm L.25mm | 4018754002900 |
| 02110010 | 456 10 | 3/8 " Socket Wrench size 10mm L.27mm | 4018754002917 |
| 02110011 | 456 11 | 3/8 " Socket Wrench size 11mm L.27mm | 4018754002924 |
| 02110012 | 456 12 | 3/8 " Socket Wrench size 12mm L.28mm | 4018754002931 |
| 02110013 | 456 13 | 3/8 " Socket Wrench size 13mm L.30mm | 4018754002948 |
| 02110014 | 456 14 | 3/8 " Socket Wrench size 14mm L.30mm | 4018754002955 |
| 02110015 | 456 15 | 3/8 " Socket Wrench size 15mm L.31mm | 4018754002962 |
| 02110016 | 456 16 | 3/8 " Socket Wrench size 16mm L.31mm | 4018754002979 |
| 02110017 | 456 17 | 3/8 " Socket Wrench size 17mm L.31mm | 4018754002986 |
| 02110018 | 456 18 | 3/8 " Socket Wrench size 18mm L.32mm | 4018754002993 |
| 02110019 | 456 19 | 3/8 " Socket Wrench size 19mm L.32mm | 4018754003006 |
| 02110020 | 456 20 | 3/8 " Socket Wrench size 20mm L.34mm | 4018754003013 |
| 02110021 | 456 21 | 3/8 " Socket Wrench size 21mm L.34mm | 4018754003020 |
| 02110022 | 456 22 | 3/8 " Socket Wrench size 22mm L.35mm | 4018754003037 |

GTIN-Code.



