



## Adapter

7370/10

Product no. 58290010  
GTIN 4018754161034  
Model 7370/10

**Label.** Adapter Tool holders 9 x 12mm Drive 14 x 18mm

- Features.**
- for using insert tools with an outer square drive of 14 x 18 mm on torque wrenches with an internal square drive of 9 x 12 mm
  - Caution! Modified settings on torque wrench

## Technologies and features.



### QuickRelease

The QuickRelease safety lock prevents unintentional loss of insert tools. These click securely into place, and are only released again at the push of a button for a quick tool change.

## Technical Drawing.

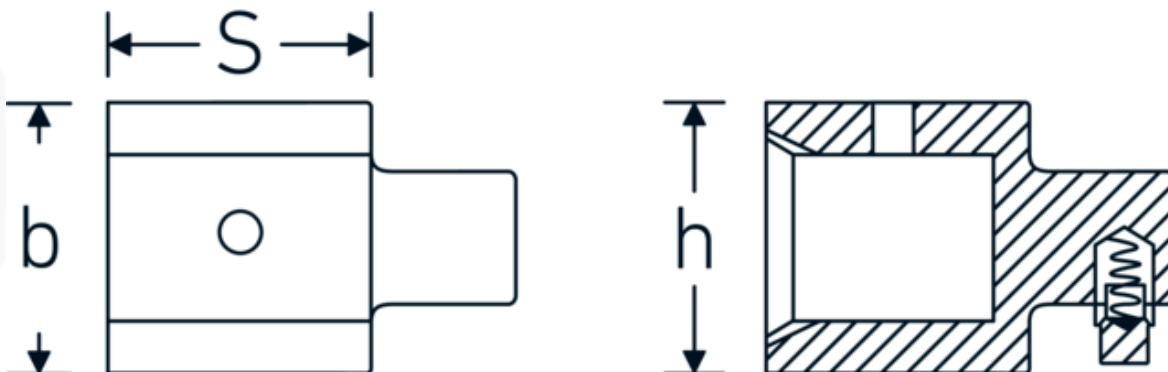

## Technical Attributes.

Internal square drive (mm)	14 x 18 mm
Width mm (b)	31 mm
Size square socket [inside square drive]	9 x 12 mm
Height mm (h)	26 mm
Length mm (L)	55 mm
S	30,5 mm

## Logistics data.

Depth mm (IFS)	55
Width mm (IFS)	45
Height mm (IFS)	27
WEEE/ElektroG	nicht ear-pflichtig
Length (packed, mm)	55
Width (packed, mm)	45
Height (packed, mm)	27
Volume (packed, dm3)	0.066825 dm3
Product no.	58290010
Weight (gross, kg)	0,120
Weight PAP (kg)	0,000
Weight PVC (kg)	0,002
GTIN	4018754161034
Country of origin AWR	GERMANY
Region of origin	Nordrhein-Westfalen
Customs tariff no.	82041100
Packing standard	1
Weight	118 g

## Variants.

Product no.	Model no. (ERP)	Description	GTIN
58290010	7370/10	Adapter Tool holders 9 x 12mm Drive 14 x 18mm	4018754161034

## GTIN-Code.



### STAHLWILLE Eduard Wille GmbH & Co. KG

Lindenallee 27 · 42349 Wuppertal · Germany · Phone: +49 202 4791-0 · Fax: +49 202 4791-200  
 info@stahlwille.de · www.stahlwille.com · Copyright by STAHLWILLE Eduard Wille GmbH & Co. KG, Wuppertal  
 Copyright by STAHLWILLE Eduard Wille GmbH & Co. KG, Wuppertal