



## Blank end insert tool

**737/40**

Product no. **58270040**  
GTIN **4018754034604**  
Model **737/40**

### Label.

Blank end insert tool Dimensions 11 x 25 Tool holders 14 x 18 L.12mm

### Features.

- gunmetal finish
- to prevent damage from excessive temperatures, the locking pin, spring and washer are not fitted until the welding work has been completed
- instructions are supplied
- material: 1.2208 - 31CRV3

## Advantages.

burnished.

## Technical Drawing.

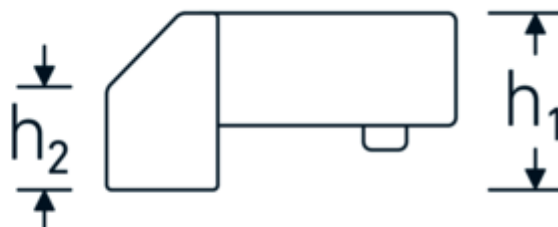
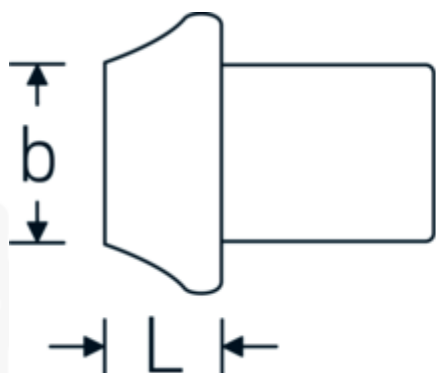

## Technical Attributes.

Welding dimensions hxb in mm	11 x 25
Size square socket [inside square drive]	14 x 18 mm
Height mm (h1)	21,5 mm
Height mm (h2)	11 mm
Length mm (L)	12 mm

## Logistics data.

Depth mm (IFS)	72
Width mm (IFS)	33
Height mm (IFS)	23
Length (packed, mm)	73
Width (packed, mm)	34
Height (packed, mm)	24
Volume (packed, dm3)	0.059568 dm3
Product no.	58270040
Weight (gross, kg)	0,100
Weight PAP (kg)	0,000
Weight PVC (kg)	0,003
GTIN	4018754034604
Country of origin AWR	GERMANY
Region of origin	Nordrhein-Westfalen
WEEE/ElektroG	nicht ear-pflichtig
Customs tariff no.	82041100
Packing standard	1
Weight	98 g

## Parts list.



91979796  
Repair + maintenance  
instruction

## Variants.

Product no.	Model no. (ERP)	Description	GTIN
58270040	737/40	Blank end insert tool Dimensions 11 x 25 Tool holders 14 x 18 L.12mm	4018754034604

## GTIN-Code.



**STAHLWILLE Eduard Wille GmbH & Co. KG**

Lindenallee 27 · 42349 Wuppertal · Germany · Phone: +49 202 4791-0 · Fax: +49 202 4791-200  
info@stahlwille.de · www.stahlwille.com · Copyright by STAHLWILLE Eduard Wille GmbH & Co. KG, Wuppertal  
Copyright by STAHLWILLE Eduard Wille GmbH & Co. KG, Wuppertal