



Blank end insert tool

737/100

Product no. 58270100
GTIN 4018754239740
Model 737/100

Label. Blank end insert tool Dimensions 15 x 50 Tool holders 22 x 28 L.24mm

- Features.**
- gunmetal finish
 - to prevent damage from excessive temperatures, the locking pin, spring and washer are not fitted until the welding work has been completed
 - instructions are supplied
 - material: 1.2208 - 31CRV3

Advantages.

burnished.

Technical Drawing.

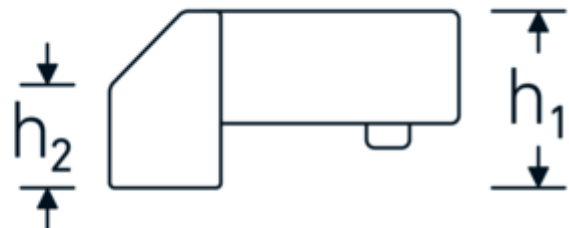
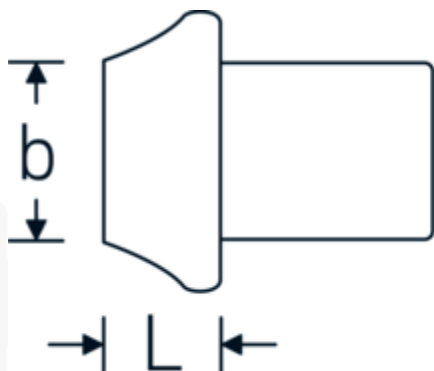

Technical Attributes.

Welding dimensions hxb in mm	15 x 50
Size square socket [inside square drive]	22 x 28 mm
Height mm (h1)	32 mm
Height mm (h2)	15 mm
Length mm (L)	24 mm

Logistics data.

Depth mm (IFS)	65
Width mm (IFS)	60
Height mm (IFS)	33
Length (packed, mm)	105
Width (packed, mm)	60
Height (packed, mm)	35
Volume (packed, dm3)	0.2205 dm3
Product no.	58270100
Weight (gross, kg)	0,490
Weight PAP (kg)	0,000
Weight PVC (kg)	0,004
GTIN	4018754239740
Country of origin AWR	GERMANY
Region of origin	Nordrhein-Westfalen
WEEE/ElektroG	nicht ear-pflichtig
Customs tariff no.	82041100
Packing standard	1
Weight	483 g

Parts list.



91979796
Repair + maintenance
instruction

Variants.

Product no.	Model no. (ERP)	Description	GTIN
58270100	737/100	Blank end insert tool Dimensions 15 x 50 Tool holders 22 x 28 L.24mm	4018754239740

GTIN-Code.



STAHLWILLE Eduard Wille GmbH & Co. KG

Lindenallee 27 · 42349 Wuppertal · Germany · Phone: +49 202 4791-0 · Fax: +49 202 4791-200
info@stahlwille.de · www.stahlwille.com · Copyright by STAHLWILLE Eduard Wille GmbH & Co. KG, Wuppertal
Copyright by STAHLWILLE Eduard Wille GmbH & Co. KG, Wuppertal