

Sockets 3/4", metric

40

Product no. 01010011
GTIN 4018754000074
Model 40 11



Label. 1/4 " hex AS-Drive® Socket Wrench size 11mm L.23mm

Technologies and features.



High Performance Quality (HPQ®)

Our HPQ® tool is made of wear-resistant high-performance steel, yet is thin-walled and lightweight. It withstands high torques and is ideal for work in confined spaces such as turbines.

Technical Drawing.

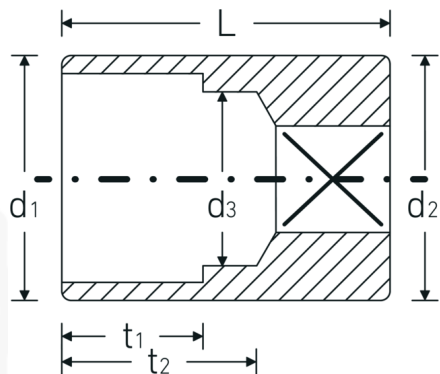

Technical Attributes.

Drive profile	hex AS-Drive®
Internal square drive (inch)	1/4 "
d1	15,5 mm
d2	15,5 mm
d3	10 mm
DIN	DIN 3124 / ISO 2725-1, ASME B 107.5M, DIN EN 3709
Length mm (L)	23 mm
Width across flats [mm]	11 mm
t1	9 mm
t2	14,6 mm

Logistics data.

Depth mm (IFS)	23
Width mm (IFS)	16
Height mm (IFS)	16
Length (packed, mm)	75
Width (packed, mm)	42
Height (packed, mm)	30
Volume (packed, dm3)	0.0945 dm3
Product no.	01010011
Weight (gross, kg)	0,190
Weight PAP (kg)	0,000
Weight PVC (kg)	0,003
GTIN	4018754000074
Country of origin	GERMANY
Region of origin	Nordrhein-Westfalen
WEEE/ElektroG	nicht ear-pflichtig
Customs tariff no.	82042000
Packing standard	10
Weight	19 g

Variants.

Product no.	Model no. (ERP)	Description	GTIN
01010003	40 3	1/4 " hex AS-Drive® Socket Wrench size 3mm L.23mm	4018754194179
01010032	40 3,2	1/4 " hex AS-Drive® Socket Wrench size 3,2mm L.23mm	4018754000111
01010035	40 3,5	1/4 " hex AS-Drive® Socket Wrench size 3,5mm L.23mm	4018754000128
01010004	40 4	1/4 " hex AS-Drive® Socket Wrench size 4mm L.23mm	4018754000005
01010045	40 4,5	1/4 " hex AS-Drive® Socket Wrench size 4,5mm L.23mm	4018754000135
01010005	40 5	1/4 " hex AS-Drive® Socket Wrench size 5mm L.23mm	4018754000012
01010055	40 5,5	1/4 " hex AS-Drive® Socket Wrench size 5,5mm L.23mm	4018754000142
01010006	40 6	1/4 " hex AS-Drive® Socket Wrench size 6mm L.23mm	4018754000029

01010007	40 7	1/4 " hex AS-Drive® Socket Wrench size 7mm L.23mm	4018754000036
01010008	40 8	1/4 " hex AS-Drive® Socket Wrench size 8mm L.23mm	4018754000043
01010009	40 9	1/4 " hex AS-Drive® Socket Wrench size 9mm L.23mm	4018754000050
01010010	40 10	1/4 " hex AS-Drive® Socket Wrench size 10mm L.23mm	4018754000067
01010011	40 11	1/4 " hex AS-Drive® Socket Wrench size 11mm L.23mm	4018754000074
01010012	40 12	1/4 " hex AS-Drive® Socket Wrench size 12mm L.23mm	4018754000081
01010013	40 13	1/4 " hex AS-Drive® Socket Wrench size 13mm L.23mm	4018754000098
01010014	40 14	1/4 " hex AS-Drive® Socket Wrench size 14mm L.24mm	4018754000104

GTIN-Code.

