

Socket

51S



Product no. **03240208**
GTIN **4018754007196**
Model **51 S 20,8**



Label. 1/2 " Socket Wrench size mm/" L.83mm

- Features.**
- long version
 - hexagon with AS-Drive profile
 - 1/2" internal square drive
 - HPQ® high performance steel, chrome-plated
 - size 20.8 mm - 13/16": with rubber insert for spark plugs
 - DIN 3124 / ISO 2725-1 / DIN EN 3710 / DIN EN 3709

Advantages.

Long

Technical Drawing.

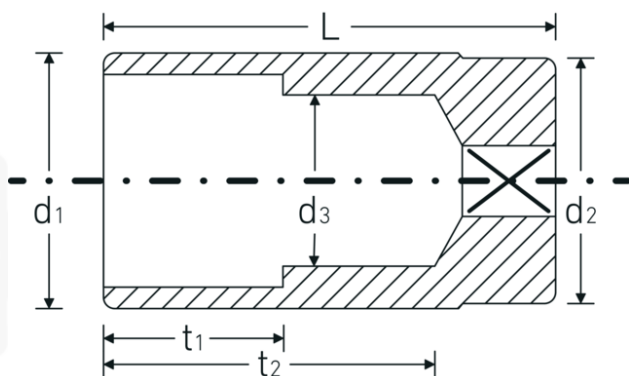

Technical Attributes.

Drive profile	Hexagon AS-Drive
Internal square drive (inch)	1/2 "
d1	27,7 mm
d2	26 mm
d3	20 mm
DIN	DIN 3124 / ISO 2725-1, DIN EN 3710, DIN EN 3709
Length mm (L)	83 mm
Width across flats [mm]	20,8 mm
Wrench size [inch]	13/16 "
t1	22 mm
t2	66,2 mm

Logistics data.

Depth mm (IFS)	83
Width mm (IFS)	28
Height mm (IFS)	28
Length (packed, mm)	145
Width (packed, mm)	90
Height (packed, mm)	54
Volume (packed, dm3)	0.7047 dm3
Product no.	03240208
Weight (gross, kg)	1,960
Weight PAP (kg)	0,000
Weight PVC (kg)	0,010
GTIN	4018754007196
Country of origin	GERMANY
Region of origin	Nordrhein-Westfalen
WEEE/ElektroG	nicht ear-pflichtig
Customs tariff no.	82042000
Packing standard	10
Weight	196 g

Variants.

Product no.	Model no. (ERP)	Description	GTIN
03240017	51 S 17	1/2 " Socket Wrench size mm L.83mm	4018754007165
03240019	51 S 19	1/2 " Socket Wrench size mm L.83mm	4018754007172
03240208	51 S 20,8	1/2 " Socket Wrench size mm/" L.83mm	4018754007196
03240022	51 S 22	1/2 " Socket Wrench size mm L.83mm	4018754007189

GTIN-Code.



