

## QuickRelease ratchet, fine tooth

### 435QR N



Product no. 12111020  
GTIN 4018754235919  
Model 435QR N



#### Label.

VDE fine-tooth ratchet 3/8 RSW.4.5° L.193mm

#### Features.

- Reversible
- 80 teeth
- With QuickRelease security lock
- With 2-component handle
- For work in confined spaces, with a working angle of only 4.5°
- FOD-preventive due to screw-less design
- DIN 3122/ISO 3315
- DBGM

## Advantages.

#### Interchangeable

Unique QR locking system – secures every component from ratchet to extension to socket without wasting space



## Technologies and features.



### QuickRelease

The QuickRelease safety lock prevents unintentional loss of insert tools. These click securely into place, and are only released again at the push of a button for a quick tool change.



### Foreign Object Damage

STAHLWILLE protects against FOD (Foreign Object Damage). Our tool is ideal for safety-relevant sectors such as aviation, thanks to the screwless design.



### Fine-tooth ratchet mechanism

Our fine-tooth ratchets with 80 teeth re-engage after just 4.5° for maximum precision in confined spaces. 8 pairs of parallel teeth simultaneously ensure maximum load-bearing capacity and particularly smooth running, even at high torques.

## Technical Attributes.

a	15 mm
External square drive (inch)	3/8
Number of teeth	80
Working angle	4.5 °
Width mm (b)	30 mm
DIN	DIN 3122 / ISO 3315
Length mm (L)	193 mm

## Logistics data.

Depth mm (IFS)	195
Width mm (IFS)	31
Height mm (IFS)	15
Length (packed, mm)	197
Width (packed, mm)	31
Height (packed, mm)	25
Volume (packed, dm <sup>3</sup> )	0.152675 dm <sup>3</sup>
Art. no.	12111020
Weight (gross, kg)	0,245
Weight PAP (kg)	0,000
Weight PVC (kg)	0,005
GTIN	4018754235919
Country of origin	GERMANY
Region of origin	Nordrhein-Westfalen
WEEE/ElektroG	nicht ear-pflichtig
Customs tariff no.	82042000
Packing standard	1
Weight	235 g

## Variants.

Art. no.	Model no. (ERP)	Description	GTIN
12111020	435QR N	VDE fine-tooth ratchet 3/8 RSW.4.5° L.193mm	4018754235919

## GTIN-Code.



## Accessories.



02501024  
CROW-FOOT spanner  
heavy-duty, inch



02501028  
CROW-FOOT spanner  
heavy-duty, inch



02501032  
CROW-FOOT spanner  
heavy-duty, inch



02501034  
CROW-FOOT spanner  
heavy-duty, inch



02501036  
CROW-FOOT spanner  
heavy-duty, inch



02501038  
CROW-FOOT spanner  
heavy-duty, inch



02501040  
CROW-FOOT spanner  
heavy-duty, inch



02501042  
CROW-FOOT spanner  
heavy-duty, inch



02501044  
CROW-FOOT spanner  
heavy-duty, inch



12180026  
Bit holder



02501046  
CROW-FOOT spanner  
heavy-duty, inch



12180030  
Bit holder



02501048  
CROW-FOOT spanner  
heavy-duty, inch



02501050  
CROW-FOOT spanner  
heavy-duty, inch



02501052  
CROW-FOOT spanner  
heavy-duty, inch



02501054  
CROW-FOOT spanner  
heavy-duty, inch



02501056  
CROW-FOOT spanner  
heavy-duty, inch



02501058  
CROW-FOOT spanner  
heavy-duty, inch



02501060  
CROW-FOOT spanner  
heavy-duty, inch



02501062  
CROW-FOOT spanner  
heavy-duty, inch

## Spare parts/spare part for.



19021020  
Spare parts set for  
ratchet No.435QR N

## Images.

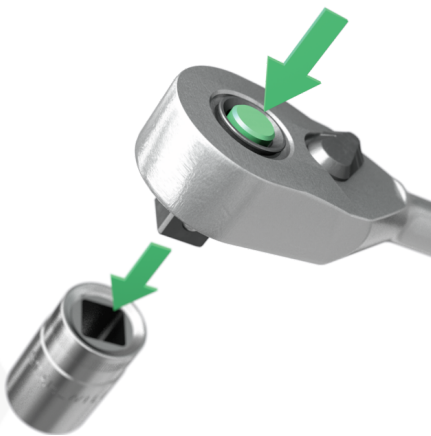



**STAHLWILLE Eduard Wille GmbH & Co. KG**

Lindenallee 27 · 42349 Wuppertal · Germany · Phone: +49 202 4791-0 · Fax: +49 202 4791-200  
info@stahlwille.de · www.stahlwille.com · Copyright by STAHLWILLE Eduard Wille GmbH & Co. KG, Wuppertal  
Copyright by STAHLWILLE Eduard Wille GmbH & Co. KG, Wuppertal