

## Doppen 3/8", metrisch, lang

46

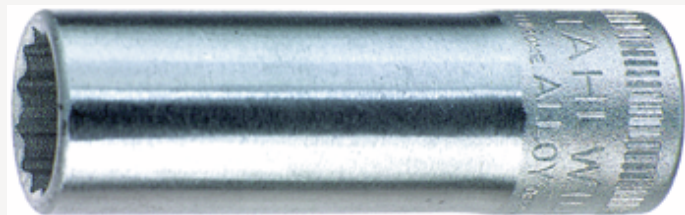

Artikelnr. 02020012  
GTIN 4018754002184  
Model 46 12



**Aanwijzing.** 3/8 " Dop Maat 12mm L.54mm

**Eigenschappen.**

- lang
- DIN 3124/ISO 2725-1, DIN EN 3710, DIN EN 3709, ASME B 107.5M
- HPQ®-high performance staal, verchromd

## Voordelen.

lang

## Technische tekening.

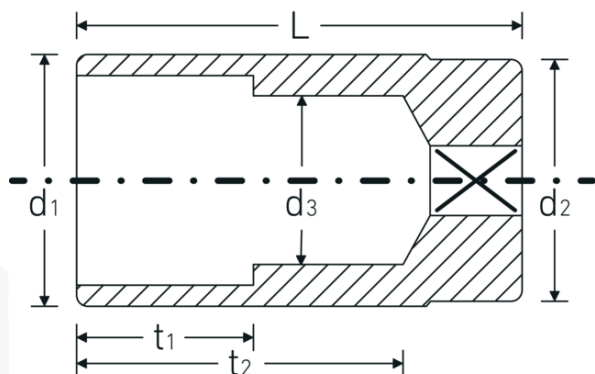

## Technische kenmerken.

|   |  |
|---|--|
| <b>Uitvoerprofiel</b>                     | Dubbel-zeskant<br>AS-drive   |
| <b>Aandrijving vierkant binnen (inch)</b> | 3/8 "  |
| <b>d1</b>                                 | 16,9 mm  |
| <b>d2</b>                                 | 17,5 mm  |
| <b>d3</b>                                 | 11 mm  |
| <b>DIN</b>                                | DIN 3124 / ISO<br>2725-1, DIN EN<br>3710, DIN EN<br>3709, ASME B<br>107.5M |
| <b>Lengte mm (L)</b>                      | 54 mm  |
| <b>Sleutelplaatdikte [mm]</b>             | 12 mm  |
| <b>t1</b>                                 | 20 mm  |
| <b>t2</b>                                 | 40,4 mm  |
| <b>Type</b>                               | BMW: 324d; 524d  |

## Logistieke gegevens.

|                              |                     |
|------------------------------|---------------------|
| <b>Diepte mm (IFS)</b>       | 54                  |
| <b>Breedte mm (IFS)</b>      | 17                  |
| <b>Hoogte mm (IFS)</b>       | 17                  |
| <b>Lengte (verpakt, mm)</b>  | 90                  |
| <b>Breedte (verpakt, mm)</b> | 57                  |
| <b>Hoogte (verpakt, mm)</b>  | 35                  |
| <b>Volume (verpakt, dm3)</b> | 0.17955 dm3         |
| <b>Artikelnr.</b>            | 02020012            |
| <b>Gewicht (bruto, KG)</b>   | 0,520               |
| <b>Gewicht PAP (KG)</b>      | 0,000               |
| <b>Gewicht PVC (KG)</b>      | 0,006               |
| <b>GTIN</b>                  | 4018754002184       |
| <b>Land van oorsprong</b>    | GERMANY             |
| <b>Regio van oorsprong</b>   | Nordrhein-Westfalen |
| <b>WEEE/ElektroG</b>         | nicht ear-pflichtig |
| <b>Douanetarief nr.</b>      | 82042000            |
| <b>Verpakkingsstandaard</b>  | 10                  |
| <b>Gewicht (g)</b>           | 57 g                |

## Varianten.

| Artikelnr. | Modelnr. (ERP)  | Beschrijving                 | GTIN          |
|------------|-----------------|------------------------------|---------------|
| 02020008   | 46 8            | 3/8 " Dop Maat 8mm L.54mm    | 4018754167661 |
| 02020010   | 46 10           | 3/8 " Dop Maat 10mm L.54mm   | 4018754002160 |
| 02020011   | 46 11           | 3/8 " Dop Maat 11mm L.54mm   | 4018754002177 |
| 02020012   | 46 12           | 3/8 " Dop Maat 12mm L.54mm   | 4018754002184 |
| 02020013   | 46 13           | 3/8 " Dop Maat 13mm L.54mm   | 4018754002191 |
| 02020014   | 46 14           | 3/8 " Dop Maat 14mm L.60mm   | 4018754002207 |
| 02020015   | 46 15           | 3/8 " Dop Maat 15mm L.60mm   | 4018754002214 |
| 02020016   | 46 16           | 3/8 " Dop Maat 16mm L.60mm   | 4018754002221 |
| 02020017   | 46 17           | 3/8 " Dop Maat 17mm L.65mm   | 4018754002238 |
| 02020018   | 46 18           | 3/8 " Dop Maat 18mm L.65mm   | 4018754002245 |
| 02020019   | 46 19           | 3/8 " Dop Maat 19mm L.65mm   | 4018754002252 |
| 02020208   | 46 20,8 - 13/16 | 3/8 " Dop Maat 20,8mm L.65mm | 4018754002290 |
| 02020021   | 46 21           | 3/8 " Dop Maat 21mm L.65mm   | 4018754002276 |
| 02020022   | 46 22           | 3/8 " Dop Maat 22mm L.65mm   | 4018754002283 |

## GTIN-code.

