

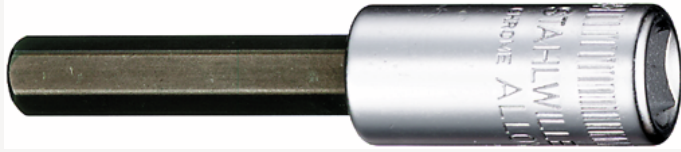

INHEX socket

44a



Product no. **01450004**
GTIN **4018754126880**
Model **44 A 1/16**



Label. INHEX socket 1/4 " 1/16 L.55mm

Features.

- for socket head screws
- DIN 7422
- Chrome Alloy Steel, chrome plated

Advantages.

For Allen screws

Technical Drawing.

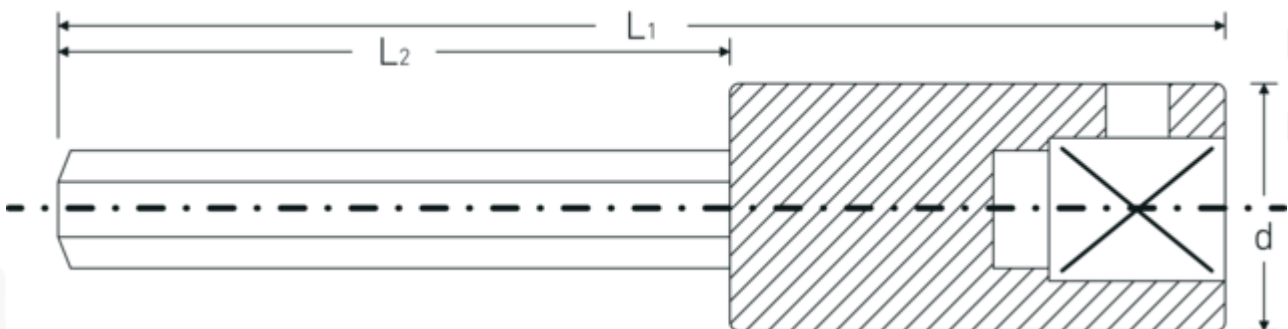

Technical Attributes.

Drive profile	Hexagonal
External hex drive (inch)	1/16

Logistics data.

Depth mm (IFS)	55
Width mm (IFS)	11

Internal square drive (inch)	1/4 "	Height mm (IFS)	11
d	10,7 mm	Length (packed, mm)	100
DIN	DIN 7422	Width (packed, mm)	60
L1	55 mm	Height (packed, mm)	11
L2	30 mm	Volume (packed, dm3)	0.066 dm3
		Art. no.	01450004
		Weight (gross, kg)	0,055
		Weight PAP (kg)	0,000
		Weight PVC (kg)	0,003
		GTIN	4018754126880
		Country of origin	GERMANY
		Region of origin	Nordrhein-Westfalen
		WEEE/ElektroG	nicht ear-pflichtig
		Customs tariff no.	82042000
		Packing standard	5
		Weight	11 g

Variants.

Art. no.	Model no. (ERP)	Description	GTIN
01450004	44 A 1/16	INHEX socket 1/4 " 1/16 L.55mm	4018754126880
01450005	44 A 5/64	INHEX socket 1/4 " 5/64 L.55mm	4018754126897
01450006	44 A 3/32	INHEX socket 1/4 " 3/32 L.55mm	4018754126903
01450007	44 A 7/64	INHEX socket 1/4 " 7/64 L.55mm	4018754126910
01450008	44 A 1/8	INHEX socket 1/4 " 1/8 L.55mm	4018754001439
01450009	44 A 9/64	INHEX socket 1/4 " 9/64 L.55mm	4018754126927
01450010	44 A 5/32	INHEX socket 1/4 " 5/32 L.55mm	4018754001446
01450012	44 A 3/16	INHEX socket 1/4 " 3/16 L.55mm	4018754126934
01450014	44 A 7/32	INHEX socket 1/4 " 7/32 L.55mm	4018754126941
01450016	44 A 1/4	INHEX socket 1/4 " 1/4 L.55mm	4018754126958

GTIN-Code.





STAHLWILLE Eduard Wille GmbH & Co. KG

Lindenallee 27 · 42349 Wuppertal · Germany · Phone: +49 202 4791-0 · Fax: +49 202 4791-200
info@stahlwille.de · www.stahlwille.com · Copyright by STAHLWILLE Eduard Wille GmbH & Co. KG, Wuppertal
Copyright by STAHLWILLE Eduard Wille GmbH & Co. KG, Wuppertal