



TORX® sockets 3/8"

45TX



Product no. **02270014**
GTIN **4018754003716**
Model **45 TX E 14**



Label. 3/8 " Socket L.28mm

Technologies and features.



High Performance Quality (HPQ®)

Our HPQ® tool is made of wear-resistant high-performance steel, yet is thin-walled and lightweight. It withstands high torques and is ideal for work in confined spaces such as turbines.

Technical Drawing.

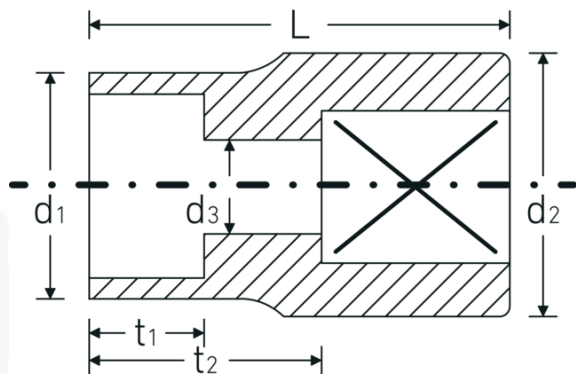

Technical Attributes.

| | |
|------------------------------|---------|
| Drive profile | TORX® |
| Internal square drive (inch) | 3/8 " |
| d1 | 16,5 mm |
| d2 | 17,3 mm |
| d3 | 8 mm |
| Size of output profile | E14 |
| Length mm (L) | 28 mm |
| t1 | 10 mm |
| t2 | 16,5 mm |

Logistics data.

| | |
|----------------------|---------------------|
| Depth mm (IFS) | 28 |
| Width mm (IFS) | 19 |
| Height mm (IFS) | 19 |
| Length (packed, mm) | 105 |
| Width (packed, mm) | 45 |
| Height (packed, mm) | 30 |
| Volume (packed, dm3) | 0.14175 dm3 |
| Product no. | 02270014 |
| Weight (gross, kg) | 0,340 |
| Weight PAP (kg) | 0,000 |
| Weight PVC (kg) | 0,006 |
| GTIN | 4018754003716 |
| Country of origin | GERMANY |
| Region of origin | Nordrhein-Westfalen |
| WEEE/ElektroG | nicht ear-pflichtig |
| Customs tariff no. | 82042000 |
| Packing standard | 10 |
| Weight | 34 g |

Variants.

| Product no. | Model no. (ERP) | Description | GTIN |
|-------------|-----------------|---------------------|---------------|
| 02270005 | 45 TX E 5 | 3/8 " Socket L.28mm | 4018754003655 |
| 02270006 | 45 TX E 6 | 3/8 " Socket L.28mm | 4018754003662 |
| 02270007 | 45 TX E 7 | 3/8 " Socket L.28mm | 4018754003679 |
| 02270008 | 45 TX E 8 | 3/8 " Socket L.28mm | 4018754003686 |
| 02270010 | 45 TX E 10 | 3/8 " Socket L.28mm | 4018754003693 |
| 02270012 | 45 TX E 12 | 3/8 " Socket L.28mm | 4018754003709 |
| 02270014 | 45 TX E 14 | 3/8 " Socket L.28mm | 4018754003716 |

GTIN-Code.



