



## TORX® sockets 1/2"

50TX

Product no. 03270011  
GTIN 4018754007264  
Model 50 TX E 11



Label. 1/2 " Socket L.38mm

## Technologies and features.



### High Performance Quality (HPQ®)

Our HPQ® tool is made of wear-resistant high-performance steel, yet is thin-walled and lightweight. It withstands high torques and is ideal for work in confined spaces such as turbines.

## Technical Drawing.

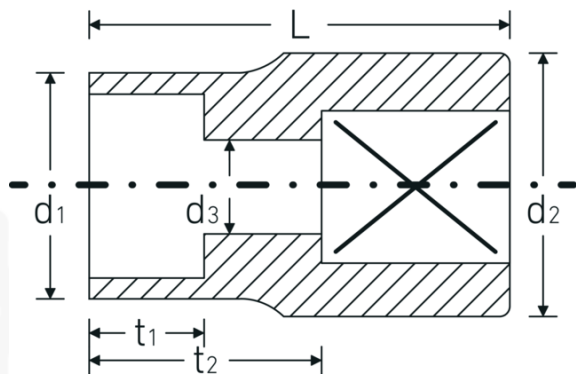

## Technical Attributes.

Drive profile	TORX®
Internal square drive (inch)	1/2 "
d1	14 mm
d2	22 mm
d3	6 mm
Size of output profile	E11
Length mm (L)	38 mm
t1	9,5 mm
t2	22 mm

## Logistics data.

Depth mm (IFS)	38
Width mm (IFS)	22
Height mm (IFS)	22
Length (packed, mm)	111
Width (packed, mm)	45
Height (packed, mm)	39
Volume (packed, dm3)	0.194805 dm3
Product no.	03270011
Weight (gross, kg)	0,550
Weight PAP (kg)	0,000
Weight PVC (kg)	0,005
GTIN	4018754007264
Country of origin	GERMANY
Region of origin	Nordrhein-Westfalen
WEEE/ElektroG	nicht ear-pflichtig
Customs tariff no.	82042000
Packing standard	10
Weight	55 g

## Variants.

Product no.	Model no. (ERP)	Description	GTIN
03270010	50 TX E 10	1/2 " Socket L.38mm	4018754007257
03270011	50 TX E 11	1/2 " Socket L.38mm	4018754007264
03270012	50 TX E 12	1/2 " Socket L.38mm	4018754007271
03270014	50 TX E 14	1/2 " Socket L.38mm	4018754007288
03270016	50 TX E 16	1/2 " Socket L.38mm	4018754007295
03270018	50 TX E 18	1/2 " Socket L.38mm	4018754007301
03270020	50 TX E 20	1/2 " Socket L.38mm	4018754007318
03270024	50 TX E 24	1/2 " Socket L.41,2mm	4018754007325

## GTIN-Code.

