

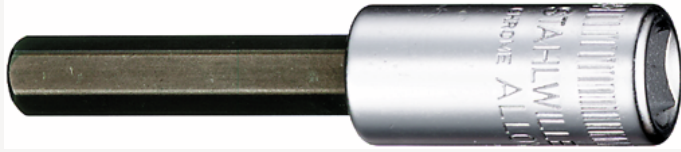

INHEX screwdriver sockets 1/4", metric

44



Product no. **01050025**
GTIN **4018754344000**
Model **44 2,5**



Label. INHEX screwdriver socket 1/4 " 2,5mm L.55mm

- Features.**
- for socket head screws
 - DIN 7422
 - Chrome Alloy Steel, chrome plated

Technical Drawing.

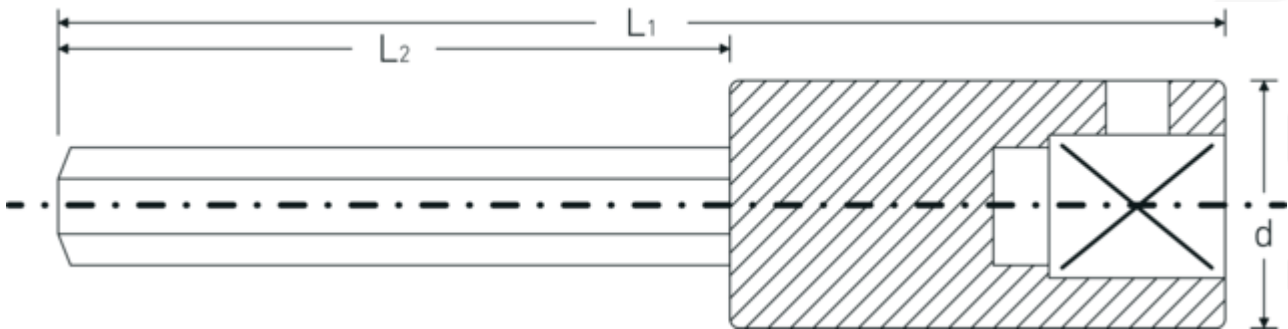

Technical Attributes.

Drive profile	Hexagon
External hex drive (mm)	2,5 mm
Internal square drive (inch)	1/4 "
d	10,7 mm
DIN	DIN 7422
L1	55 mm
L2	30 mm

Logistics data.

Depth mm (IFS)	55
Width mm (IFS)	20
Height mm (IFS)	20
Length (packed, mm)	75
Width (packed, mm)	22
Height (packed, mm)	22
Volume (packed, dm3)	0.0363 dm3

Art. no.	01050025
Weight (gross, kg)	0,055
Weight PAP (kg)	0,000
Weight PVC (kg)	0,000
GTIN	4018754344000
Country of origin	GERMANY
Region of origin	Nordrhein-Westfalen
WEEE/ElektroG	nicht ear-pflichtig
Customs tariff no.	82079030
Packing standard	1
Weight	18 g

Variants.

Art. no.	Model no. (ERP)	Description	GTIN
01050025	44 2,5	INHEX screwdriver socket 1/4 " 2,5mm L.55mm	4018754344000
01050003	44 3	INHEX socket 1/4 " 3mm L.55mm	4018754000470
01050004	44 4	INHEX socket 1/4 " 4mm L.55mm	4018754000487
01050005	44 5	INHEX socket 1/4 " 5mm L.55mm	4018754000494
01050006	44 6	INHEX socket 1/4 " 6mm L.55mm	4018754000500

GTIN-Code.



STAHLWILLE Eduard Wille GmbH & Co. KG

Lindenallee 27 · 42349 Wuppertal · Germany · Phone: +49 202 4791-0 · Fax: +49 202 4791-200
 info@stahlwille.de · www.stahlwille.com · Copyright by STAHLWILLE Eduard Wille GmbH & Co. KG, Wuppertal
 Copyright by STAHLWILLE Eduard Wille GmbH & Co. KG, Wuppertal