

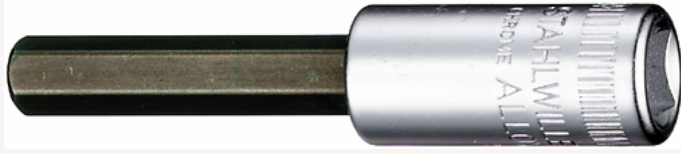

## INHEX socket

44



Product no. **01050005**  
GTIN **4018754000494**  
Model **44 5**



**Label.** INHEX socket 1/4 " 5mm L.55mm

- Features.**
- for socket head screws
  - DIN 7422
  - Chrome Alloy Steel, chrome plated

## Advantages.

For Allen screws

## Technical Drawing.

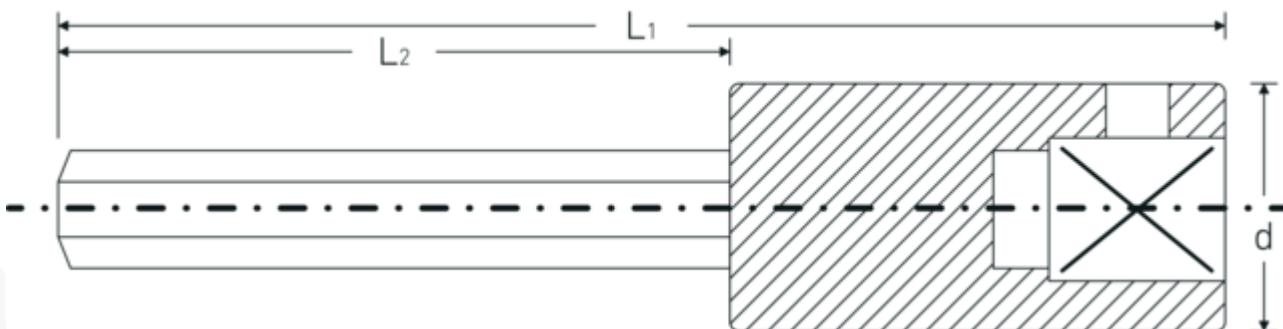

## Technical Attributes.

Drive profile Hexagon  
External hex drive (mm) 5 mm

## Logistics data.

Depth mm (IFS) 55  
Width mm (IFS) 11

Internal square drive (inch)	1/4 "	Height mm (IFS)	11
d	10,7 mm	Length (packed, mm)	85
DIN	DIN 7422	Width (packed, mm)	45
L1	55 mm	Height (packed, mm)	12
L2	30 mm	Volume (packed, dm3)	0.0459 dm3
		Art. no.	01050005
		Weight (gross, kg)	0,095
		Weight PAP (kg)	0,000
		Weight PVC (kg)	0,003
		GTIN	4018754000494
		Country of origin	GERMANY
		Region of origin	Nordrhein-Westfalen
		WEEE/ElektroG	nicht ear-pflichtig
		Customs tariff no.	82042000
		Packing standard	5
		Weight	25 g

## Variants.

Art. no.	Model no. (ERP)	Description	GTIN
01050025	44 2,5	INHEX screwdriver socket 1/4 " 2,5mm L.55mm	4018754344000
01050003	44 3	INHEX socket 1/4 " 3mm L.55mm	4018754000470
01050004	44 4	INHEX socket 1/4 " 4mm L.55mm	4018754000487
01050005	44 5	INHEX socket 1/4 " 5mm L.55mm	4018754000494
01050006	44 6	INHEX socket 1/4 " 6mm L.55mm	4018754000500

## GTIN-Code.



### STAHLWILLE Eduard Wille GmbH & Co. KG

Lindenallee 27 · 42349 Wuppertal · Germany · Phone: +49 202 4791-0 · Fax: +49 202 4791-200  
 info@stahlwille.de · www.stahlwille.com · Copyright by STAHLWILLE Eduard Wille GmbH & Co. KG, Wuppertal  
 Copyright by STAHLWILLE Eduard Wille GmbH & Co. KG, Wuppertal