



## QR fine-tooth ratchet set, 1/4"+1/2"

415QR/512QR



Product no. **91336421**  
GTIN **4018754342914**  
Model **415QR/512QR Knarrensatz**



**Label.** QR fine tooth ratchet set 2 pcs.

- Features.**
- QuickRelease ratchet set with 1/4" and 1/2" drives
  - With QuickRelease safety lock, secure fit and easy release of socket spanners and connecting parts
  - To work in confined spaces, with a working angle of only 4.5°
  - FOD-preventive due to screw-less design
  - Made of high-quality chrome alloy steel
  - 2-component handles made of impact-resistant, Skydrol-resistant plastic
  - Easy-to-use switch lever for left/right rotation
  - DIN 3122/ISO 3315
  - DBGM
- Contents 2-piece set:**  
1 QR fine-tooth ratchet 1/4" **no. 415QR:** L. 117 mm  
1 QR fine-tooth ratchet 1/2" **no. 512QR:** L. 265.5 mm

## Advantages.

Made in Germany – interchangeable STAHLWILLE ratchet with 2-component handle, 80 sprockets, QR push button release, DIN 3122/ISO 3315, chrome alloy steel, chrome-plated

Patented QuickRelease locking system – secures every component from ratchet to extension to socket

80 sprockets allow for a working angle of only 4.5° – facilitating efficient working even in confined spaces



## Technologies and features.



### QuickRelease

The QuickRelease safety lock prevents unintentional loss of insert tools. These click securely into place, and are only released again at the push of a button for a quick tool change.



### Foreign Object Damage

STAHLWILLE protects against FOD (Foreign Object Damage). Our tool is ideal for safety-relevant sectors such as aviation, thanks to the screwless design.



### Fine-tooth ratchet mechanism

Our fine-tooth ratchets with 80 teeth re-engage after just 4.5° for maximum precision in confined spaces. 8 pairs of parallel teeth simultaneously ensure maximum load-bearing capacity and particularly smooth running, even at high torques.

## Technical Attributes.

Number of tools	2 pcs.
Width mm (b)	90 mm
DIN	DIN 3122 / ISO 3315
Height mm (h)	40 mm
Length mm (L)	310 mm

## Logistics data.

Depth mm (IFS)	310
Width mm (IFS)	90
Height mm (IFS)	40
Length (packed, mm)	310
Width (packed, mm)	90
Height (packed, mm)	40
Volume (packed, dm <sup>3</sup> )	1.116 dm <sup>3</sup>
Art. no.	91336421
Weight (gross, kg)	0,808
Weight PAP (kg)	0,030
Weight PVC (kg)	0,010
GTIN	4018754342914
Country of origin	GERMANY
Region of origin	Nordrhein-Westfalen

WEEE/ElektroG	nicht ear-pflichtig
Customs tariff no.	82042000
Packing standard	1
Weight	808 g

## Parts list.



13111120 VDE fine-tooth ratchet	11111020 VDE fine-tooth ratchet
------------------------------------	------------------------------------

## Variants.

Art. no.	Model no. (ERP)	Description	GTIN
91336421	415QR/512QR Knarrensatz	QR fine tooth ratchet set 2 pcs.	4018754342914

## GTIN-Code.



## Spare parts/spare part for.



19012020  
Spare parts set for  
ratchet No.415QR N,  
415QRL N, 415SG-QR  
N, 416QR, 418QR



19040040  
Spare parts set for  
ratchet No.512QR N

## Images.

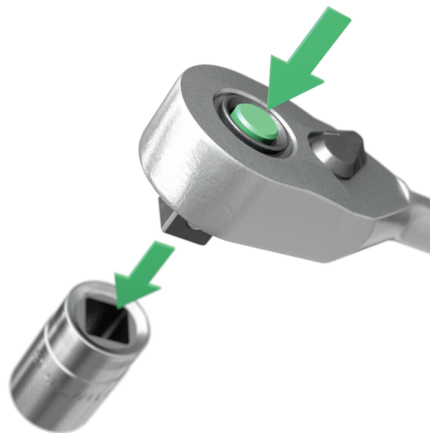

**STAHLWILLE Eduard Wille GmbH & Co. KG**

Lindenallee 27 · 42349 Wuppertal · Germany · Phone: +49 202 4791-0 · Fax: +49 202 4791-200  
info@stahlwille.de · www.stahlwille.com · Copyright by STAHLWILLE Eduard Wille GmbH & Co. KG, Wuppertal  
Copyright by STAHLWILLE Eduard Wille GmbH & Co. KG, Wuppertal