



Sockets

40TX

Product no. **01270007**
GTIN **4018754000968**
Model **40 TX E 7**



Label. 1/4 " Sockets L.23mm

Features.

- for external TORX® screws
- HPQ® high performance steel, chrome plated

Advantages.

For external TORX® screws.

Technologies and features.



High Performance Quality (HPQ®)

Our HPQ® tool is made of wear-resistant high-performance steel, yet is thin-walled and lightweight. It withstands high torques and is ideal for work in confined spaces such as turbines.

Technical Drawing.

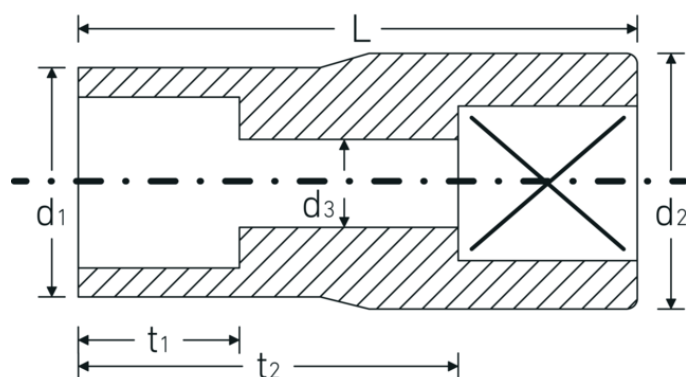

Technical Attributes.

Drive profile	TORX®
Internal square drive (inch)	1/4 "
d1	9,6 mm
d2	10,7 mm
d3	3,8 mm
Size of output profile	E7
Length mm (L)	23 mm
t1	6,5 mm
t2	15 mm

Logistics data.

Depth mm (IFS)	25
Width mm (IFS)	11
Height mm (IFS)	11
Length (packed, mm)	75
Width (packed, mm)	50
Height (packed, mm)	11
Volume (packed, dm ³)	0.04125 dm ³
Art. no.	01270007
Weight (gross, kg)	0,100
Weight PAP (kg)	0,000
Weight PVC (kg)	0,002
GTIN	4018754000968
Country of origin	GERMANY
Region of origin	Nordrhein-Westfalen
WEEE/ElektroG	nicht ear-pflichtig
Customs tariff no.	82042000
Packing standard	10
Weight	10 g

Variants.

Art. no.	Model no. (ERP)	Description	GTIN
01270004	40 TX E 4	1/4 " Sockets L.23mm	4018754000937
01270005	40 TX E 5	1/4 " Sockets L.23mm	4018754000944
01270006	40 TX E 6	1/4 " Sockets L.23mm	4018754000951

01270007	40 TX E 7	1/4 " Sockets L.23mm	4018754000968
01270008	40 TX E 8	1/4 " Sockets L.23mm	4018754000975
01270010	40 TX E 10	1/4 " Sockets L.23mm	4018754000982

GTIN-Code.



STAHLWILLE Eduard Wille GmbH & Co. KG

Lindenallee 27 · 42349 Wuppertal · Germany · Phone: +49 202 4791-0 · Fax: +49 202 4791-200
info@stahlwille.de · www.stahlwille.com · Copyright by STAHLWILLE Eduard Wille GmbH & Co. KG, Wuppertal
Copyright by STAHLWILLE Eduard Wille GmbH & Co. KG, Wuppertal