

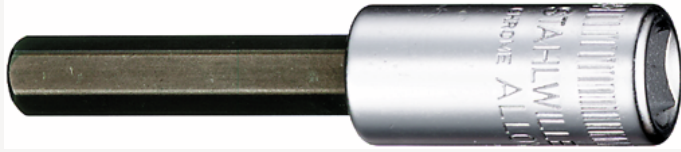

INHEX socket

44



Product no. **01050003**
GTIN **4018754000470**
Model **44 3**



Label. INHEX socket 1/4 " 3mm L.55mm

Features.

- for socket head screws
- DIN 7422
- Chrome Alloy Steel, chrome plated

Advantages.

For Allen screws

Technical Drawing.

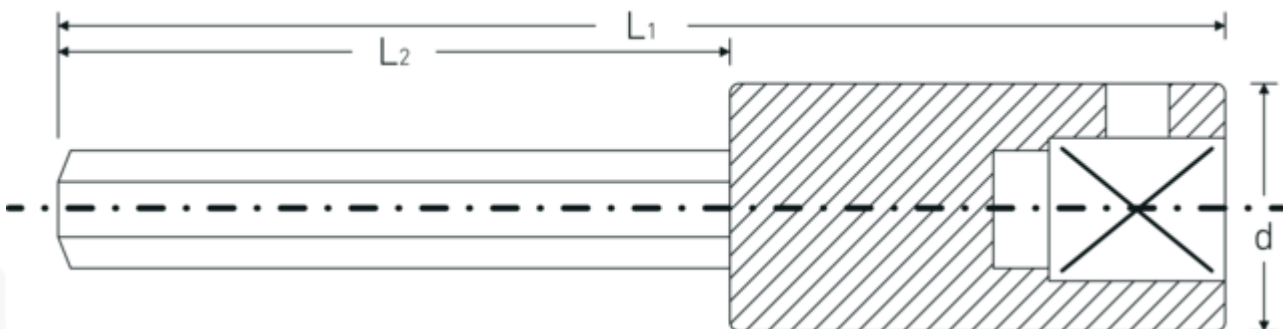

Technical Attributes.

Drive profile Hexagon
External hex drive (mm) 3 mm

Logistics data.

Depth mm (IFS) 55
Width mm (IFS) 11

Internal square drive (inch)	1/4 "	Height mm (IFS)	11
d	10,7 mm	Length (packed, mm)	80
DIN	DIN 7422	Width (packed, mm)	45
L1	55 mm	Height (packed, mm)	12
L2	30 mm	Volume (packed, dm3)	0.0432 dm3
		Art. no.	01050003
		Weight (gross, kg)	0,073
		Weight PAP (kg)	0,000
		Weight PVC (kg)	0,002
		GTIN	4018754000470
		Country of origin	GERMANY
		Region of origin	Nordrhein-Westfalen
		WEEE/ElektroG	nicht ear-pflichtig
		Customs tariff no.	82042000
		Packing standard	5
		Weight	20 g

Variants.

Art. no.	Model no. (ERP)	Description	GTIN
01050025	44 2,5	INHEX screwdriver socket 1/4 " 2,5mm L.55mm	4018754344000
01050003	44 3	INHEX socket 1/4 " 3mm L.55mm	4018754000470
01050004	44 4	INHEX socket 1/4 " 4mm L.55mm	4018754000487
01050005	44 5	INHEX socket 1/4 " 5mm L.55mm	4018754000494
01050006	44 6	INHEX socket 1/4 " 6mm L.55mm	4018754000500

GTIN-Code.



STAHLWILLE Eduard Wille GmbH & Co. KG

Lindenallee 27 · 42349 Wuppertal · Germany · Phone: +49 202 4791-0 · Fax: +49 202 4791-200
 info@stahlwille.de · www.stahlwille.com · Copyright by STAHLWILLE Eduard Wille GmbH & Co. KG, Wuppertal
 Copyright by STAHLWILLE Eduard Wille GmbH & Co. KG, Wuppertal