

Spark plug socket

3466

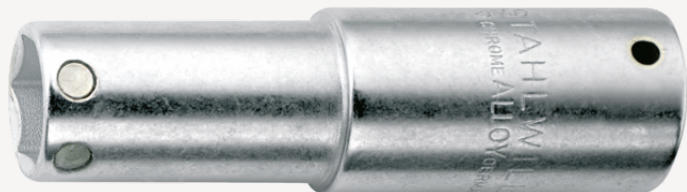

Product no. **02140036**
GTIN **4018754003242**
Model **3466 16- 5/8**



Label. 3/8 " Spark plug socket Wrench size 16mm L.85mm

Features.

- long version, with magnet
- hexagon with AS-Drive profile
- 3/8" internal square drive
- HPQ® high performance steel, chrome-plated

Advantages.

Long

Technical Drawing.

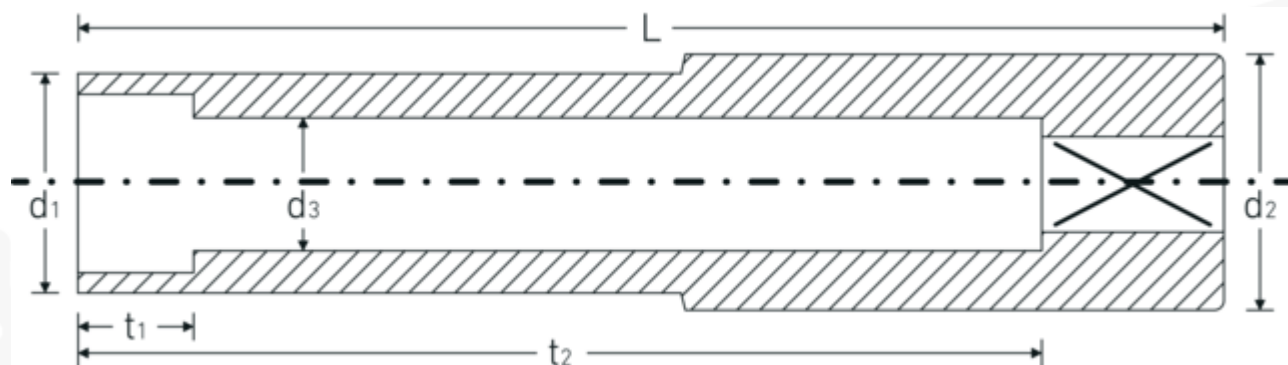

Technical Attributes.

Drive profile	Hexagon AS-Drive
Internal square drive (inch)	3/8 "
d1	21,8 mm
d2	25,5 mm
d3	15 mm
Length mm (L)	85 mm
Width across flats [mm]	16 mm
Wrench size [inch]	5/8 "
t1	7 mm
t2	72,9 mm

Logistics data.

Depth mm (IFS)	85
Width mm (IFS)	25
Height mm (IFS)	25
Length (packed, mm)	95
Width (packed, mm)	75
Height (packed, mm)	53
Volume (packed, dm3)	0.377625 dm3
Product no.	02140036
Weight (gross, kg)	0,925
Weight PAP (kg)	0,000
Weight PVC (kg)	0,008
GTIN	4018754003242
Country of origin	GERMANY
Region of origin	Nordrhein-Westfalen
WEEE/ElektroG	nicht ear-pflichtig
Customs tariff no.	82042000
Packing standard	5
Weight	180 g

Variants.

Product no.	Model no. (ERP)	Description	GTIN
02140036	3466 16- 5/8	3/8 " Spark plug socket Wrench size 16mm L.85mm	4018754003242

GTIN-Code.

