

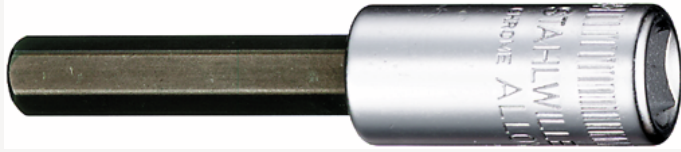

## INHEX socket

44



Product no. **01050006**  
GTIN **4018754000500**  
Model **44 6**



**Label.** INHEX socket 1/4 " 6mm L.55mm

**Features.**

- for socket head screws
- DIN 7422
- Chrome Alloy Steel, chrome plated

## Advantages.

For Allen screws

## Technical Drawing.

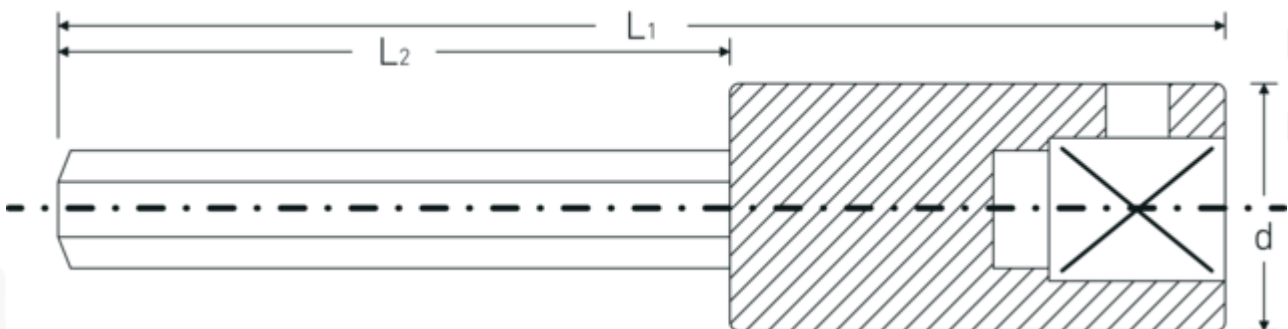

## Technical Attributes.

Drive profile	Hexagon
External hex drive (mm)	6 mm

## Logistics data.

Depth mm (IFS)	55
Width mm (IFS)	12

<b>Internal square drive (inch)</b>	1/4 "	<b>Height mm (IFS)</b>	12
<b>d</b>	11,6 mm	<b>Length (packed, mm)</b>	83
<b>DIN</b>	DIN 7422	<b>Width (packed, mm)</b>	53
<b>L1</b>	55 mm	<b>Height (packed, mm)</b>	13
<b>L2</b>	30 mm	<b>Volume (packed, dm3)</b>	0.057187 dm3
		<b>Art. no.</b>	01050006
		<b>Weight (gross, kg)</b>	0,110
		<b>Weight PAP (kg)</b>	0,000
		<b>Weight PVC (kg)</b>	0,002
		<b>GTIN</b>	4018754000500
		<b>Country of origin</b>	GERMANY
		<b>Region of origin</b>	Nordrhein-Westfalen
		<b>WEEE/ElektroG</b>	nicht ear-pflichtig
		<b>Customs tariff no.</b>	82042000
		<b>Packing standard</b>	5
		<b>Weight</b>	30 g

## Variants.

Art. no.	Model no. (ERP)	Description	GTIN
01050025	44 2,5	INHEX screwdriver socket 1/4 " 2,5mm L.55mm	4018754344000
01050003	44 3	INHEX socket 1/4 " 3mm L.55mm	4018754000470
01050004	44 4	INHEX socket 1/4 " 4mm L.55mm	4018754000487
01050005	44 5	INHEX socket 1/4 " 5mm L.55mm	4018754000494
01050006	44 6	INHEX socket 1/4 " 6mm L.55mm	4018754000500

## GTIN-Code.



### STAHLWILLE Eduard Wille GmbH & Co. KG

Lindenallee 27 · 42349 Wuppertal · Germany · Phone: +49 202 4791-0 · Fax: +49 202 4791-200  
 info@stahlwille.de · www.stahlwille.com · Copyright by STAHLWILLE Eduard Wille GmbH & Co. KG, Wuppertal  
 Copyright by STAHLWILLE Eduard Wille GmbH & Co. KG, Wuppertal