

QuickRelease ratchet, fine tooth

435SG-QR N



Product no. **12111030**
GTIN **4018754284313**
Model **435SG-QRN**



Label.

QuickRelease ratchet, fine tooth 3/8 RSW.4.5° L.193mm

Features.

- reversible
- 80 teeth
- with QuickRelease safety lock
- with steel handle
- for use in confined spaces, re-engages after movement of 4.5°
- construction without screws prevents foreign object damage
- DIN 3122/ISO 3315
- registered design

Advantages.

Interchangeable

Unique QR locking system – secures every component from ratchet to extension to socket without wasting space

Technologies and features.



QuickRelease

The QuickRelease safety lock prevents unintentional loss of insert tools. These click securely into place, and are only released again at the push of a button for a quick tool change.



Foreign Object Damage

STAHLWILLE protects against FOD (Foreign Object Damage). Our tool is ideal for safety-relevant sectors such as aviation, thanks to the screwless design.



Fine-tooth ratchet mechanism

Our fine-tooth ratchets with 80 teeth re-engage after just 4.5° for maximum precision in confined spaces. 8 pairs of parallel teeth simultaneously ensure maximum load-bearing capacity and particularly smooth running, even at high torques.

Technical Attributes.

a	15 mm
External square drive (inch)	3/8
Number of teeth	80
Working angle	4.5 °
Width mm (b)	30 mm
DIN	DIN 3122 / ISO 3315
Length mm (L)	193 mm

Logistics data.

Depth mm (IFS)	190
Width mm (IFS)	30
Height mm (IFS)	27
Length (packed, mm)	190
Width (packed, mm)	30
Height (packed, mm)	27
Volume (packed, dm ³)	0.1539 dm ³
Art. no.	12111030
Weight (gross, kg)	0,272
Weight PAP (kg)	0,000
Weight PVC (kg)	0,006
GTIN	4018754284313
Country of origin	GERMANY
Region of origin	Nordrhein-Westfalen
WEEE/ElektroG	nicht ear-pflichtig
Customs tariff no.	82042000
Packing standard	1
Weight	272 g

Variants.

Art. no.	Model no. (ERP)	Description	GTIN
12111030	435SG-QRN	QuickRelease ratchet, fine tooth 3/8 RSW.4.5° L.193mm	4018754284313

GTIN-Code.



Accessories.



02501024
CROW-FOOT spanner
heavy-duty, inch



12030001
Adapter



12030003
Adapter



02501028
CROW-FOOT spanner
heavy-duty, inch



02501032
CROW-FOOT spanner
heavy-duty, inch



02501034
CROW-FOOT spanner
heavy-duty, inch



02501036
CROW-FOOT spanner
heavy-duty, inch



02501038
CROW-FOOT spanner
heavy-duty, inch



02501040
CROW-FOOT spanner
heavy-duty, inch



02501042
CROW-FOOT spanner
heavy-duty, inch



02501044
CROW-FOOT spanner
heavy-duty, inch



12180026
Bit holder



02501046
CROW-FOOT spanner
heavy-duty, inch



12180030
Bit holder



02501048
CROW-FOOT spanner
heavy-duty, inch



02501050
CROW-FOOT spanner
heavy-duty, inch



02501052
CROW-FOOT spanner
heavy-duty, inch



02501054
CROW-FOOT spanner
heavy-duty, inch



02501056
CROW-FOOT spanner
heavy-duty, inch



02501058
CROW-FOOT spanner
heavy-duty, inch



02501060
CROW-FOOT spanner
heavy-duty, inch



02501062
CROW-FOOT spanner
heavy-duty, inch

Spare parts/spare part for.



19021020
Spare parts set for
ratchet No.435QR N

Images.

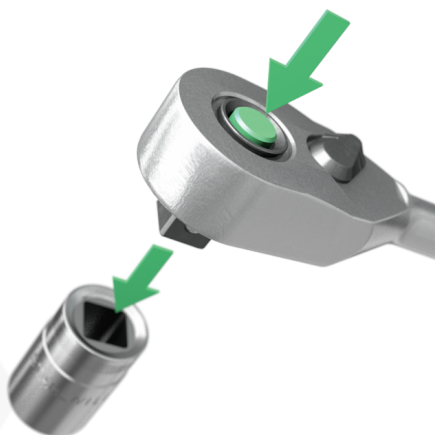



STAHLWILLE Eduard Wille GmbH & Co. KG

Lindenallee 27 · 42349 Wuppertal · Germany · Phone: +49 202 4791-0 · Fax: +49 202 4791-200
info@stahlwille.de · www.stahlwille.com · Copyright by STAHLWILLE Eduard Wille GmbH & Co. KG, Wuppertal
Copyright by STAHLWILLE Eduard Wille GmbH & Co. KG, Wuppertal