



Sockets 1/4", inch

40a

Product no. **01410032**
GTIN **4018754001309**
Model **40 A 1/2**



Label.

1/4 " Socket Wrench size 1/2" L.23mm

Technologies and features.



High Performance Quality (HPQ®)

Our HPQ® tool is made of wear-resistant high-performance steel, yet is thin-walled and lightweight. It withstands high torques and is ideal for work in confined spaces such as turbines.

Technical Drawing.

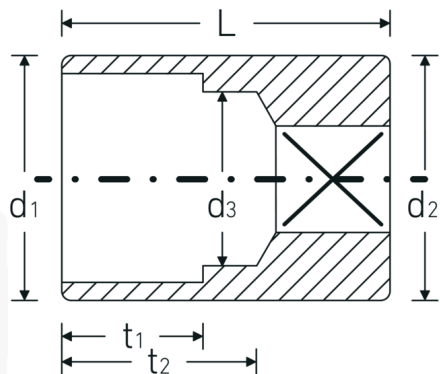

Technical Attributes.

Drive profile	hex AS-Drive®
Internal square drive (inch)	1/4 "
d1	17,3 mm
d2	17,3 mm
d3	11,5 mm
Length mm (L)	23 mm
Wrench size [inch]	1/2 "
t1	9,5 mm
t2	14,1 mm

Logistics data.

Depth mm (IFS)	23
Width mm (IFS)	18
Height mm (IFS)	18
Length (packed, mm)	90
Width (packed, mm)	46
Height (packed, mm)	18
Volume (packed, dm3)	0.07452 dm3
Product no.	01410032
Weight (gross, kg)	0,274
Weight PAP (kg)	0,000
Weight PVC (kg)	0,003
GTIN	4018754001309
Country of origin	GERMANY
Region of origin	Nordrhein-Westfalen
WEEE/ElektroG	nicht ear-pflichtig
Customs tariff no.	82042000
Packing standard	10
Weight	27 g

Variants.

Product no.	Model no. (ERP)	Description	GTIN
01410008	40 A 1/8	1/4 " Socket Wrench size 1/8" L.23mm	4018754180349
01410010	40 A 5/32	1/4 " Socket Wrench size 5/32" L.23mm	4018754001217
01410012	40 A 3/16	1/4 " Socket Wrench size 3/16" L.23mm	4018754001224
01410014	40 A 7/32	1/4 " Socket Wrench size 7/32" L.23mm	4018754001231
01410016	40 A 1/4	1/4 " Socket Wrench size 1/4" L.23mm	4018754001248
01410018	40 A 9/32	1/4 " Socket Wrench size 9/32" L.23mm	4018754001255
01410020	40 A 5/16	1/4 " Socket Wrench size 5/16" L.23mm	4018754001262
01410022	40 A 11/32	1/4 " Socket Wrench size 11/32" L.23mm	4018754001279
01410024	40 A 3/8	1/4 " Socket Wrench size 3/8" L.23mm	4018754001286
01410028	40 A 7/16	1/4 " Socket Wrench size 7/16" L.23mm	4018754001293
01410032	40 A 1/2	1/4 " Socket Wrench size 1/2" L.23mm	4018754001309
01410034	40 A 9/16	1/4 " Socket Wrench size 9/16" L.24mm	4018754001316

GTIN-Code.

