

TORX® sockets 3/8"

45TX



Product no. **02270008**
GTIN **4018754003686**
Model **45 TX E 8**



Label. 3/8 " Socket L.28mm

Technologies and features.



High Performance Quality (HPQ®)

Our HPQ® tool is made of wear-resistant high-performance steel, yet is thin-walled and lightweight. It withstands high torques and is ideal for work in confined spaces such as turbines.

Technical Drawing.

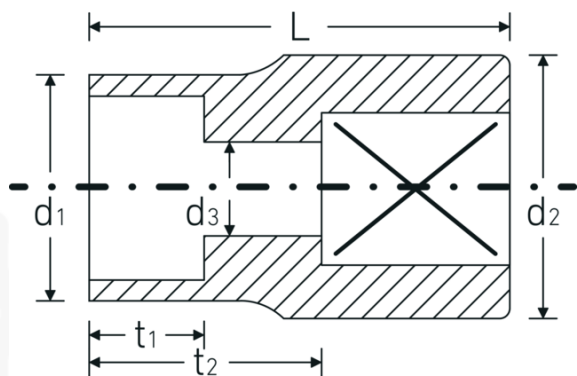

Technical Attributes.

Drive profile	TORX®
Internal square drive (inch)	3/8 "
d1	10,5 mm
d2	16,5 mm
d3	4,3 mm
Size of output profile	E8
Length mm (L)	28 mm
t1	7 mm
t2	16,5 mm

Logistics data.

Depth mm (IFS)	28
Width mm (IFS)	17
Height mm (IFS)	17
Length (packed, mm)	95
Width (packed, mm)	40
Height (packed, mm)	30
Volume (packed, dm3)	0.114 dm3
Product no.	02270008
Weight (gross, kg)	0,220
Weight PAP (kg)	0,000
Weight PVC (kg)	0,003
GTIN	4018754003686
Country of origin	GERMANY
Region of origin	Nordrhein-Westfalen
WEEE/ElektroG	nicht ear-pflichtig
Customs tariff no.	82042000
Packing standard	10
Weight	22 g

Variants.

Product no.	Model no. (ERP)	Description	GTIN
02270005	45 TX E 5	3/8 " Socket L.28mm	4018754003655
02270006	45 TX E 6	3/8 " Socket L.28mm	4018754003662
02270007	45 TX E 7	3/8 " Socket L.28mm	4018754003679
02270008	45 TX E 8	3/8 " Socket L.28mm	4018754003686
02270010	45 TX E 10	3/8 " Socket L.28mm	4018754003693
02270012	45 TX E 12	3/8 " Socket L.28mm	4018754003709
02270014	45 TX E 14	3/8 " Socket L.28mm	4018754003716

GTIN-Code.



