

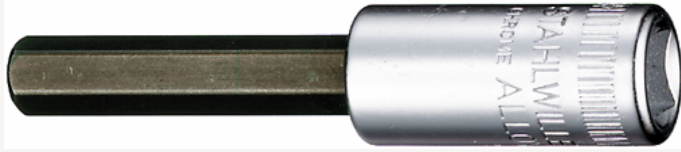

## INHEX screwdriver sockets 1/4", metric

44



Product no. **01050005**  
GTIN **4018754000494**  
Model **44 5**



**Label.** INHEX screwdriver socket 1/4 " 5mm L.55mm

### Technical Drawing.

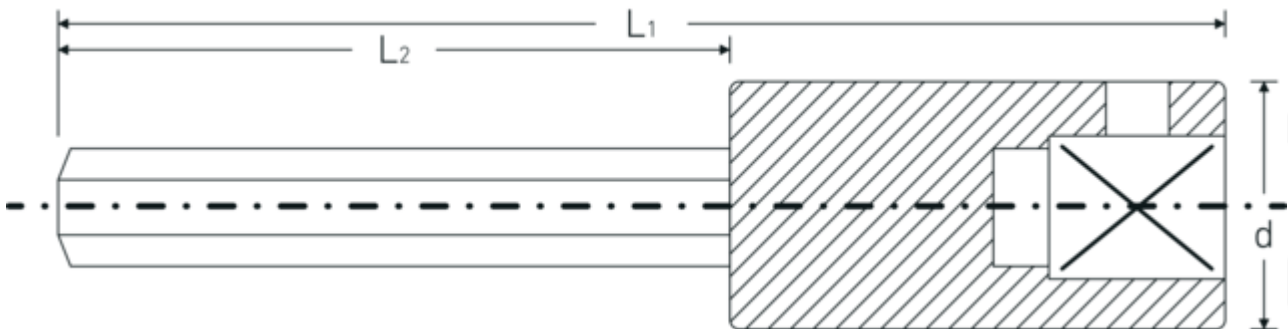

### Technical Attributes.

Drive profile	hex
External hex drive (mm)	5 mm
Internal square drive (inch)	1/4 "
d	10,7 mm
DIN	DIN 7422
L1	55 mm
L2	30 mm

### Logistics data.

Depth mm (IFS)	55
Width mm (IFS)	11
Height mm (IFS)	11
Length (packed, mm)	85
Width (packed, mm)	45
Height (packed, mm)	12
Volume (packed, dm <sup>3</sup> )	0.0459 dm <sup>3</sup>
Product no.	01050005
Weight (gross, kg)	0,095
Weight PAP (kg)	0,000

Weight PVC (kg)	0,003
GTIN	4018754000494
Country of origin	GERMANY
Region of origin	Nordrhein-Westfalen
WEEE/ElektroG	nicht ear-pflichtig
Customs tariff no.	82042000
Packing standard	5
Weight	25 g

## Variants.

Product no.	Model no. (ERP)	Description	GTIN
01050025	44 2,5	INHEX screwdriver socket 1/4 " 2,5mm L.55mm	4018754344000
01050003	44 3	INHEX screwdriver socket 1/4 " 3mm L.55mm	4018754000470
01050004	44 4	INHEX screwdriver socket 1/4 " 4mm L.55mm	4018754000487
01050005	44 5	INHEX screwdriver socket 1/4 " 5mm L.55mm	4018754000494
01050006	44 6	INHEX screwdriver socket 1/4 " 6mm L.55mm	4018754000500

## GTIN-Code.

