



## Sockets 1/4", inch

### 40aDV



Product no. 01650014  
GTIN 4018754001743  
Model 40 ADV 7/32



Label. 1/4 " Socket Wrench size 7/32" L.31,8mm

## Technologies and features.



### High Performance Quality (HPQ®)

Our HPQ® tool is made of wear-resistant high-performance steel, yet is thin-walled and lightweight. It withstands high torques and is ideal for work in confined spaces such as turbines.

## Technical Drawing.

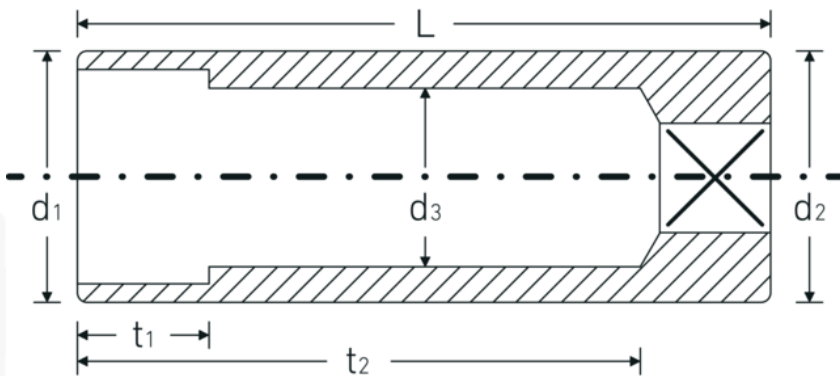

## Technical Attributes.

Drive profile	bi-hex AS-Drive®
Internal square drive (inch)	1/4 "
d1	8,6 mm
d2	10,7 mm
d3	5 mm
Length mm (L)	31,8 mm
Wrench size [inch]	7/32 "
t1	6 mm
t2	23,8 mm

## Logistics data.

Depth mm (IFS)	32
Width mm (IFS)	11
Height mm (IFS)	11
Length (packed, mm)	90
Width (packed, mm)	50
Height (packed, mm)	18
Volume (packed, dm <sup>3</sup> )	0.081 dm <sup>3</sup>
Product no.	01650014
Weight (gross, kg)	0,120
Weight PAP (kg)	0,000
Weight PVC (kg)	0,003
GTIN	4018754001743
Country of origin	GERMANY
Region of origin	Nordrhein-Westfalen
WEEE/ElektroG	nicht ear-pflichtig
Customs tariff no.	82042000
Packing standard	10
Weight	12 g

## Variants.

Product no.	Model no. (ERP)	Description	GTIN
01650014	40 ADV 7/32	1/4 " Socket Wrench size 7/32" L.31,8mm	4018754001743
01650016	40 ADV 1/4	1/4 " Socket Wrench size 1/4" L.31,8mm	4018754001750
01650018	40 ADV 9/32	1/4 " Socket Wrench size 9/32" L.31,8mm	4018754001767
01650020	40 ADV 5/16	1/4 " Socket Wrench size 5/16" L.31,8mm	4018754001774

## GTIN-Code.



