

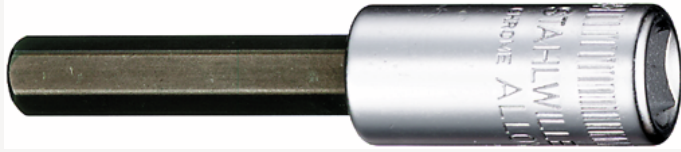

## INHEX socket

44a



Product no. **01450006**  
GTIN **4018754126903**  
Model **44 A 3/32**



**Label.** INHEX socket 1/4 " 3/32 L.55mm

**Features.**

- for socket head screws
- DIN 7422
- Chrome Alloy Steel, chrome plated

## Advantages.

For Allen screws

## Technical Drawing.

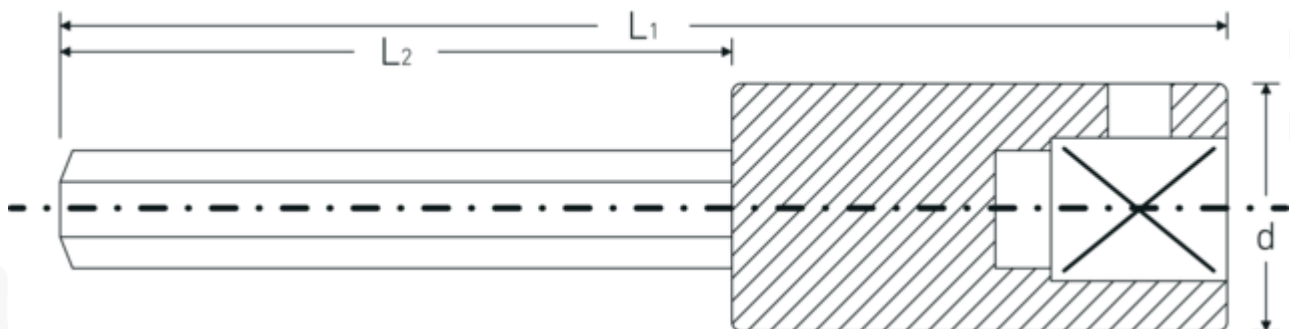

## Technical Attributes.

Drive profile Hexagonal  
External hex drive (inch) 3/32

## Logistics data.

Depth mm (IFS) 55  
Width mm (IFS) 11

<b>Internal square drive (inch)</b>	1/4 "	<b>Height mm (IFS)</b>	11
<b>d</b>	10,7 mm	<b>Length (packed, mm)</b>	100
<b>DIN</b>	DIN 7422	<b>Width (packed, mm)</b>	60
<b>L1</b>	55 mm	<b>Height (packed, mm)</b>	11
<b>L2</b>	30 mm	<b>Volume (packed, dm3)</b>	0.066 dm3
		<b>Art. no.</b>	01450006
		<b>Weight (gross, kg)</b>	0,074
		<b>Weight PAP (kg)</b>	0,000
		<b>Weight PVC (kg)</b>	0,003
		<b>GTIN</b>	4018754126903
		<b>Country of origin</b>	GERMANY
		<b>Region of origin</b>	Nordrhein-Westfalen
		<b>WEEE/ElektroG</b>	nicht ear-pflichtig
		<b>Customs tariff no.</b>	82042000
		<b>Packing standard</b>	5
		<b>Weight</b>	14 g

## Variants.

Art. no.	Model no. (ERP)	Description	GTIN
01450004	44 A 1/16	INHEX socket 1/4 " 1/16 L.55mm	4018754126880
01450005	44 A 5/64	INHEX socket 1/4 " 5/64 L.55mm	4018754126897
01450006	44 A 3/32	INHEX socket 1/4 " 3/32 L.55mm	4018754126903
01450007	44 A 7/64	INHEX socket 1/4 " 7/64 L.55mm	4018754126910
01450008	44 A 1/8	INHEX socket 1/4 " 1/8 L.55mm	4018754001439
01450009	44 A 9/64	INHEX socket 1/4 " 9/64 L.55mm	4018754126927
01450010	44 A 5/32	INHEX socket 1/4 " 5/32 L.55mm	4018754001446
01450012	44 A 3/16	INHEX socket 1/4 " 3/16 L.55mm	4018754126934
01450014	44 A 7/32	INHEX socket 1/4 " 7/32 L.55mm	4018754126941
01450016	44 A 1/4	INHEX socket 1/4 " 1/4 L.55mm	4018754126958

## GTIN-Code.





**STAHLWILLE Eduard Wille GmbH & Co. KG**

Lindenallee 27 · 42349 Wuppertal · Germany · Phone: +49 202 4791-0 · Fax: +49 202 4791-200  
info@stahlwille.de · www.stahlwille.com · Copyright by STAHLWILLE Eduard Wille GmbH & Co. KG, Wuppertal  
Copyright by STAHLWILLE Eduard Wille GmbH & Co. KG, Wuppertal